

ANDROID NAVIGATION INSTALLATION MANUAL



CONTENTS

About us	1
What you need to know?	2
1. Installation Notes	3
1.1 Pinout diagram of the device connector.....	3
1.2 Wiring Diagram	3
1.3 Introduction on the back of the machine	4
1.4 CANBUS Connection & Use	5
1.5 How to connect the rear camera?	7
1.6 How the buttons on the steering wheel work?.....	8
1.7 How to adjust the car door direction?.....	9
1.8 Can't turn off the DVD when my car is shut down?.....	10
1.9 Install USB DVR	11
1.10 Install USB TPMS	12
2. Basic operation	13
2.1 Turning On and Turning Off	13
2.2 Panel Function Button	13
2.3 Tips for Using Touch Screen	14
3. Function operation	15
3.1 Basic Settings	15
3.1.1 User Defined Home Screen	15
3.1.2 Setting Wallpaper	15
3.2 General	16
3.2.1 Steering Wheel	16
3.2.2 Screen Calibration	16
3.2.3 Navigation application	16
3.2.4 Language	17
3.2.5 Factory settings	18
3.2.6 Split screen	18
3.2.7 Float video settings	19
3.3 Navigation	20
3.4 Radio	21
3.4.1 Function Description	21
3.4.2 Select radio region	22
3.4.3 Problems you may encounter?.....	22
3.4.4 How to use Carplay?	23
3.4.5 How to use Android Auto?.....	23
4. Trouble handle	24
5. Hot product for this machine	26

About US

Jansite independently develops and produces safe and quality products to help people drive safer and easier.

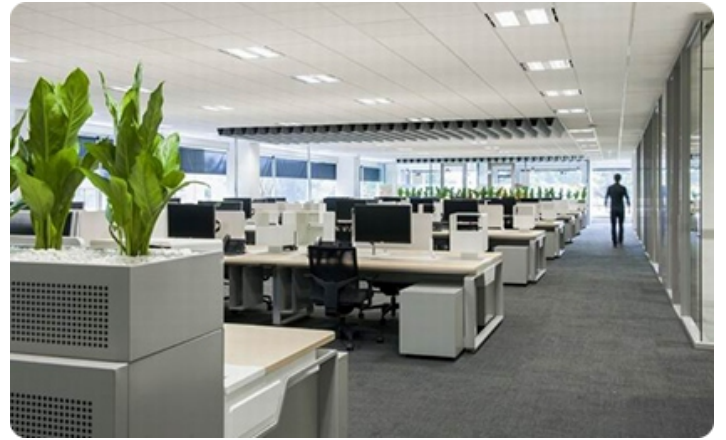

From planning, development, molding to production, Jansite has full scale research and development and manufacturing capabilities.

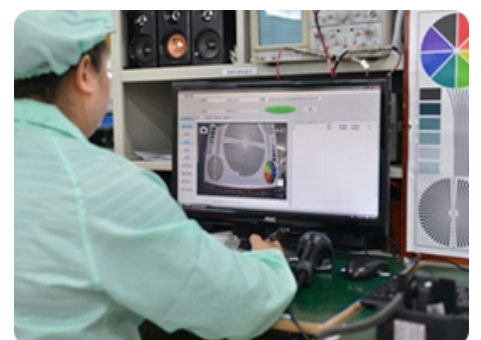

What you need to know?

In order to allow you to better install and use the machine, we have specially compiled this manual, which summarizes the problems and solutions of common problems in installation and use.

Before installing and using the machine, I hope you read the following carefully:

1. Regarding the use of the machine:

For your safety, please do not watch videos and operate the machine while driving. Adjust the volume to a level where you can hear outside sounds while driving. Before proceeding, please read this manual carefully to help you better install and use the machine.

2. After successful installation, please give us a **5-star feedback. Your support is our driving force!**



3. If this manual does not solve your problem, please do not worry, contact us, we will help you solve the problem.

Please Do Not Choose the following wrong practices:

① **Give us bad feedback** ❌

(Negative attitude does not solve the problem);

② **Open the dispute** ❌

(Dispute is handled by AliExpress, AliExpress is not professional and cannot solve your fundamental problem).

Please choose the right approach:

① **Describe your problem in detail and take photos for us to view** ✅

(For example, some models in different countries, the power cable may be different, at this time, please take photos to us, after we confirm, we will send you the power cable, you see, solving the problem is so simple);

② **Wait for our solution** ✅

(The world is divided into different time zones, so working hours are different, we can't respond immediately, please don't worry, after we see your message, we will give you a solution to the problem and leave a message to you.)



1. Installation Notes

1.1 Pinout diagram of the device connector

Pay attention to the correct wiring.
Improper connection may damage the device.

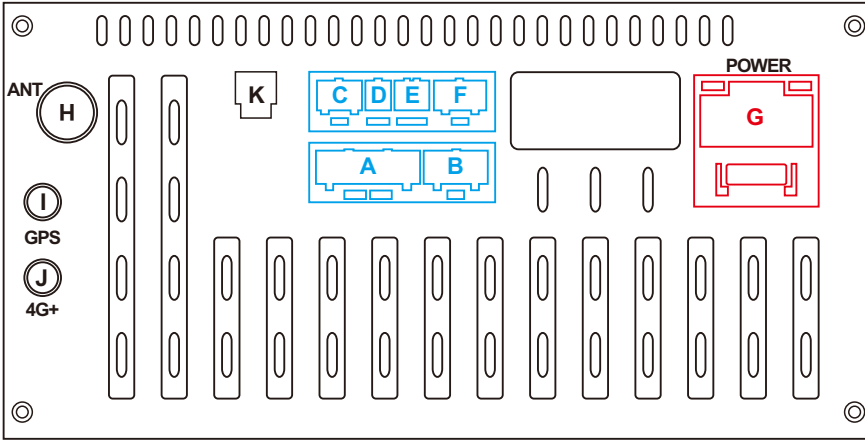

- A:** Audio / Video Connector
- B:** Redundant expansion (not allowed third-party connectors)
- C:** CANBUS Connector
- D:** USB(4 PIN)
- E:** USB(6 PIN)
- F:** Reverse Video Out
- G:** Main Power Cable
- H:** Radio
- I:** GPS
- J:** 4G Antenna
- K:** Optical audio output

1.2 Wiring Diagram

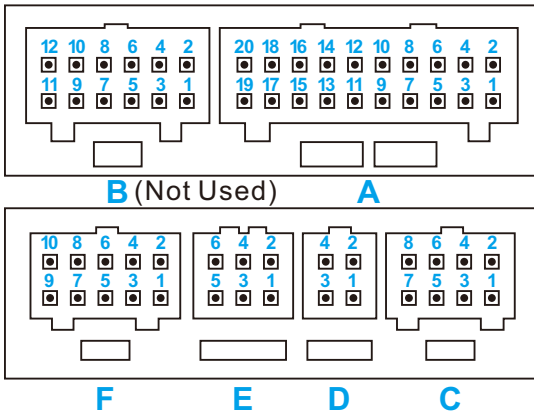

- A**
- A1: AMP_POW (Amplifier control)
- A2: GND (RCA_FL/RCA_FR)
- A3: AUXIN_R (Right channel input)
- A4: RCA_FL (Front left audio output)
- A5: AUXIN_L (Left channel input)
- A6: RCA_FR (Front right audio output)
- A7: NC (Not used)
- A8: GND (AUX IN_L/AUXIN_R)
- A9: NC (Not used)
- A10: GND (CVBS_IN2)

- A11: NC (Not used)
- A12: GND ground (CVBS_IN1/CVBS_OUT)
- A13: NC (Not used)
- A14: NC (Not used)
- A15: NC (Not used)
- A16: SUB subwoofer output
- A17: CVBS_IN2 video input 2
- A18: CVBS_IN1 video input 1
- A19: MIC-microphone -
- A20: MIC+ microphone +

- C**
- C1: GND (AUX IN_L/AUXIN_R)
- C2: POW_12V
- C3: AUX2_L
- C4: AUX2_R
- C5: KEY_RST
- C6: IPOD_DET
- C7: CAN_TXD(CANBUS)
- C8: CAN_TXD(CANBUS)

- D**
- D1: USB_5V
- D2: USB_DP0 USB0
- D3: GND USB
- D4: USB_DN0 USB0

- E**
- E1: USB_5V
- E2: USB_DP1 USB1
- E3: GND USB
- E4: USB_DN1 USB1
- E5: USB_DN2 USB2
- E6: USB_DP2 USB2

- F**
- F1: TXD_TPMS OBD
- F2: NC (Not used)
- F3: RXD_TPMS OBD
- F4: GND
- F5: POW_5V(TPMS)
- F6: CAM_CVBS(Reverse image)
- F7: CAM_12V(Reverse image)
- F8: CVBS_GND(Reverse image)
- F9: PARK_IN(Hand brake detection)
- F10: GND

G: Main Power Cable

- G1: GND
- G2: B+ 12V
- G3: ACC +12V
- G4: ILL (Car headlights)
- G5: Reverse Detection
- G6: KEY 2
- G7: KEY 1
- G8: Automatic Antenna Power Supply
- G9: FR- (Speaker Front Right)
- G10: RL- (Speaker Rear Left)
- G11: FR+ (Speaker Front Right)
- G12: RL+ (Speaker Rear Left)
- G13: FL+ (Speaker Front Left)
- G14: RR+ (Speaker Rear Right)
- G15: FL+ (Speaker Front Left)
- G16: RR- (Speaker Rear Right)

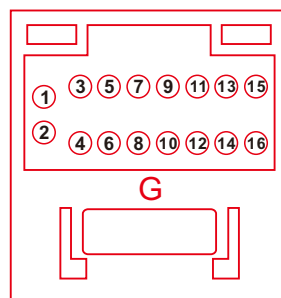

1.3 Introduction on the back of the machine:

Please install various cables correctly according to the illustration.



Optical audio output

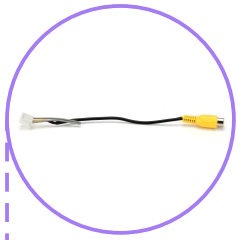

Camera Input



USB(6PIN)



USB(4PIN)



CANBUS Connector

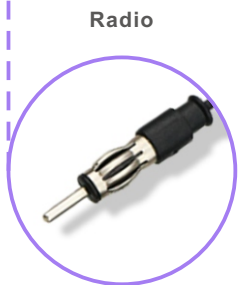
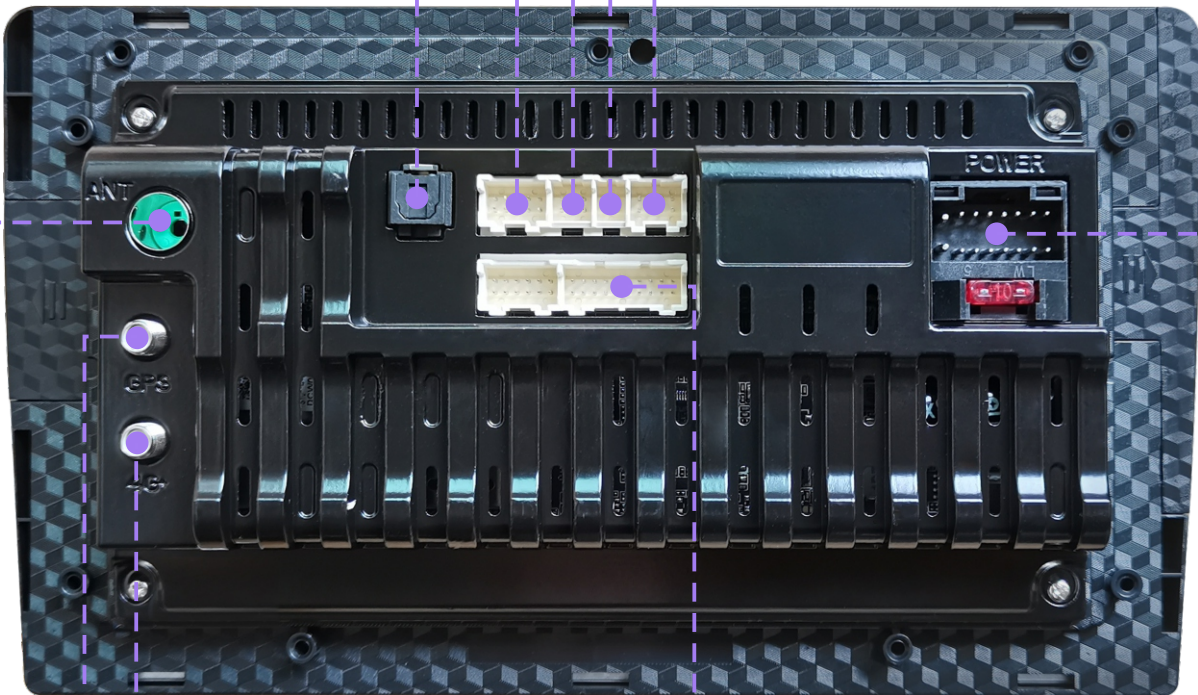

Radio



GPS



4G Antenna



RCA Cable



Power Cable

1.4 CANBUS Connection & Use

The radio is divided into those that require CANBUS and those that do not. The function of CANBUS is to make certain original car functions work normally, such as steering wheel control, original car camera and so on.

Most original car radios only have the function of listening to the radio and do not need CANBUS without a display or an original camera.

We will set up CANBUS before sending the machine. The buyer can plug and play when the machine is received. If there is a problem, the buyer can check and set CANBUS according to the CANBUS brand and model or send your CANBUS option interface to us .

The common CANBUS brands are as follows:



Raise (RZC)



Hiworld (HW)



Xinbas (XBS)



Binary (BNR)



Simple soft (XP)

1.4.1 CANBUS wiring diagram (example model: Volkswagen)

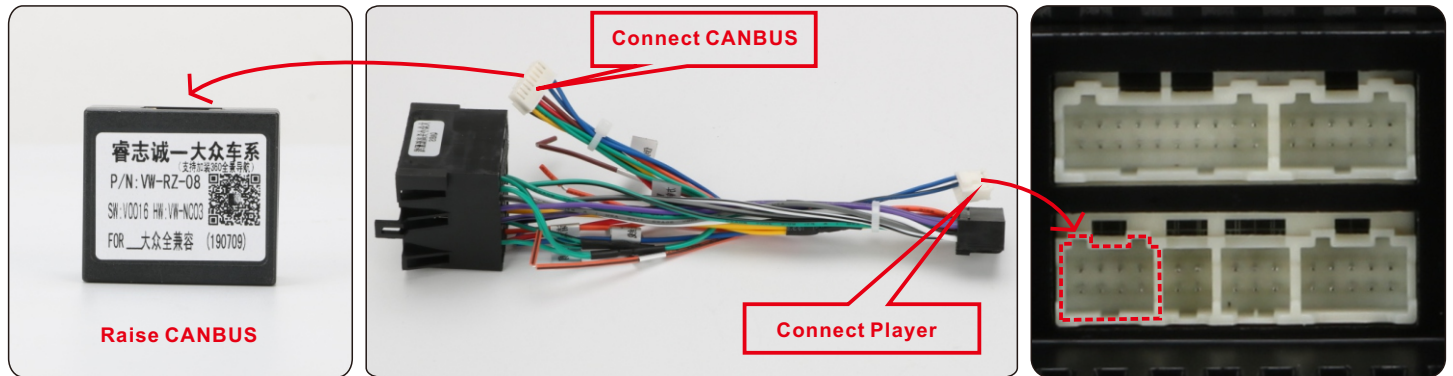

1.4.2 CANBUS settings (example model: Volkswagen)

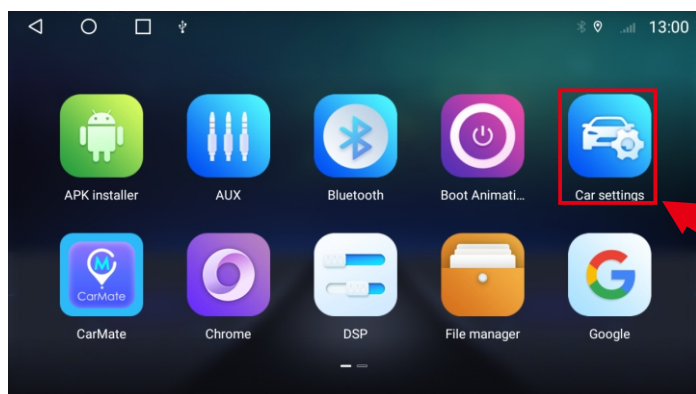

1. Click "Car Settings".

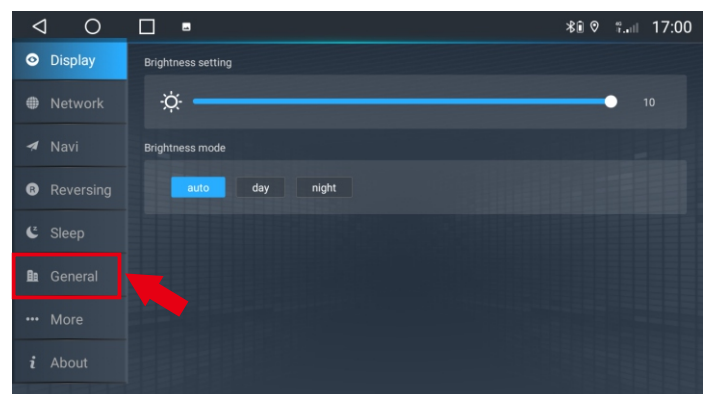

2. Click "General".

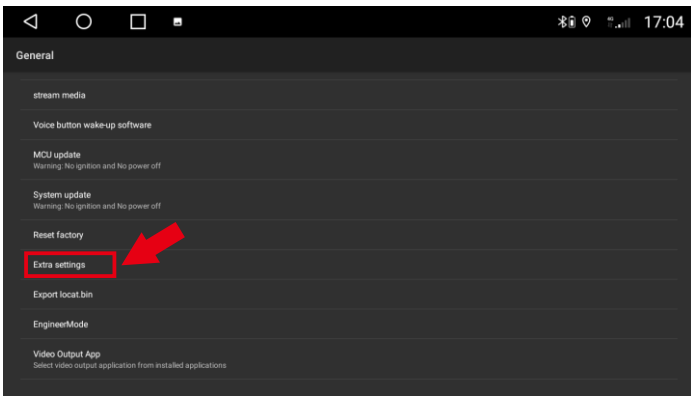

3. Enter "Extra settings" .

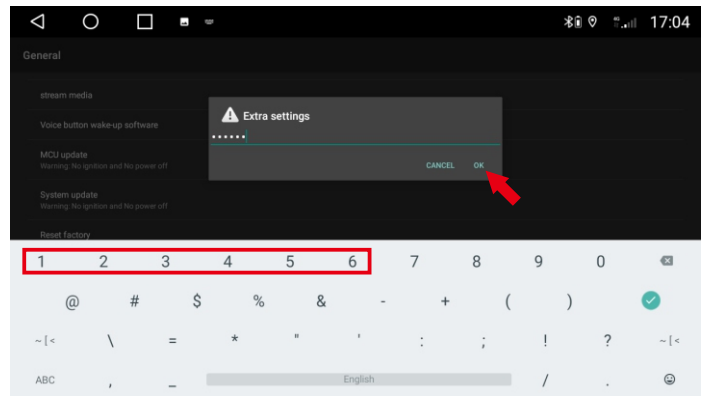

4. Enter password: 123456, click "OK".

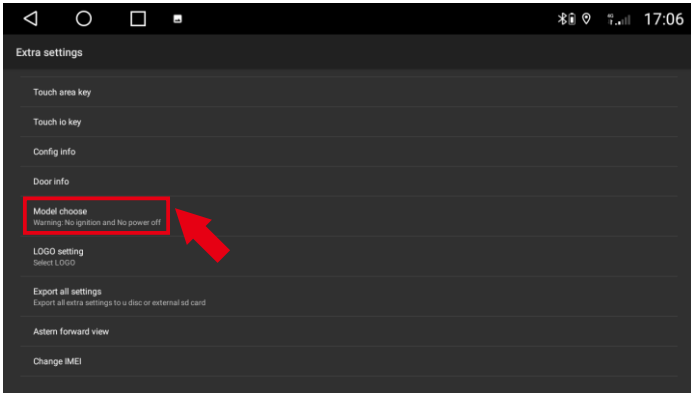

5. Enter "Model choose" .

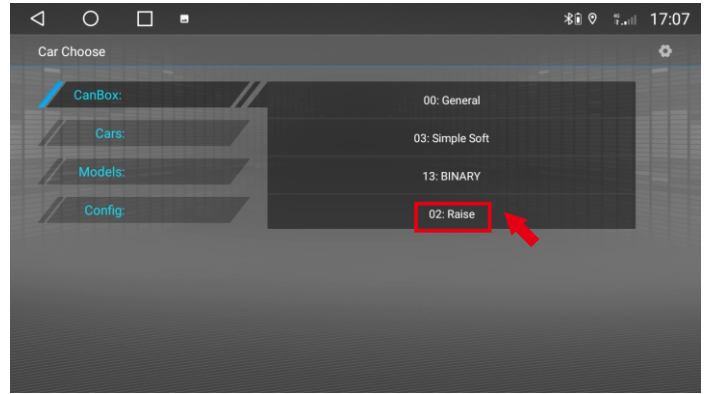

6. Click "Raise"(CANBUS Brand).

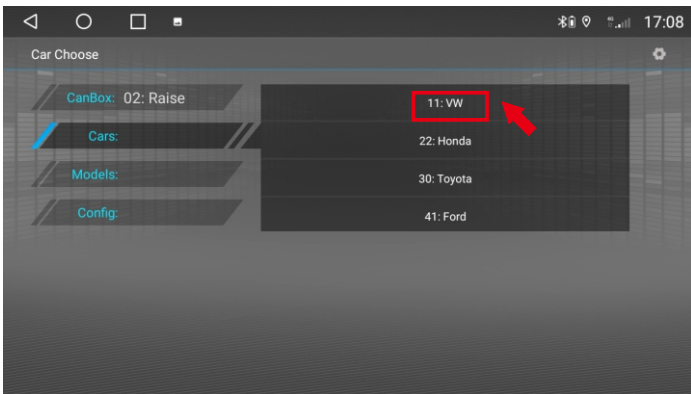

7. Click "VW"(Car Brand).

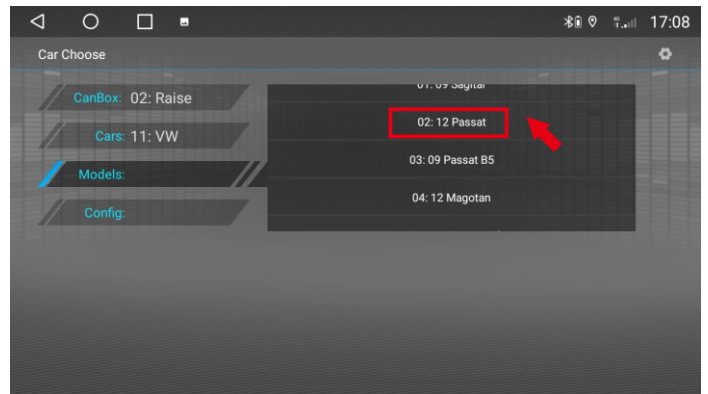

8. Click "02:12 Passat"(Car year and model).

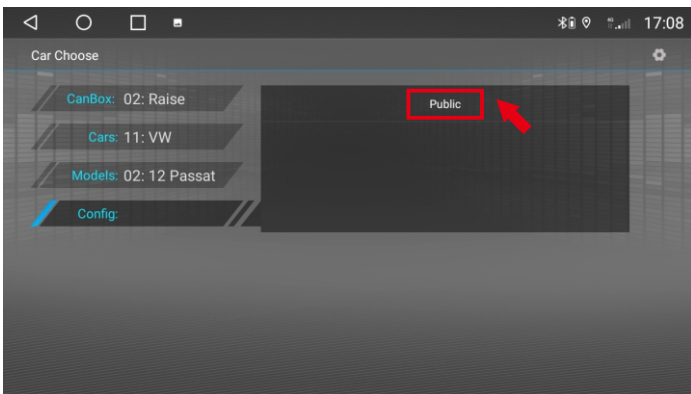

9. Click "Public"

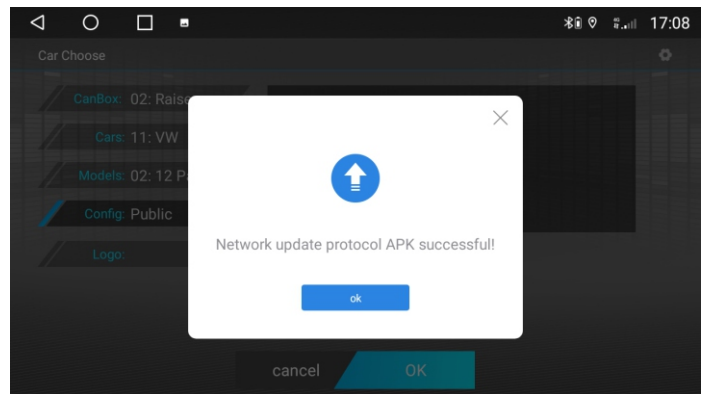

10. Waiting download (need connect Internet)

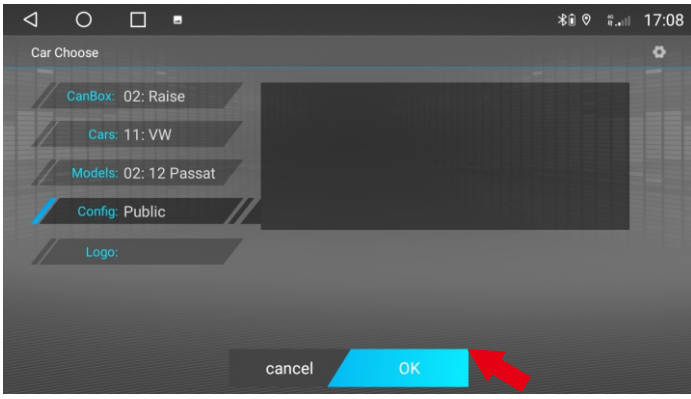

11. After upgrade is successful, click "OK".

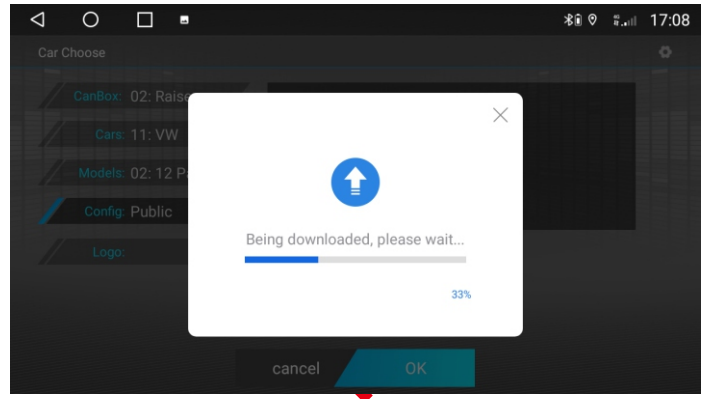

12. Waiting download (need connect Internet)

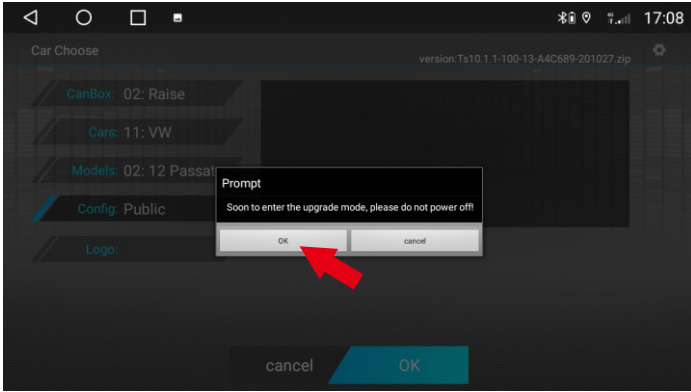

13. Click "OK" , wait for restart (Do not power off).

1.5 How to connect the rear camera?

If you need to install a rear camera, please connect as shown below.

- ① is connected to the reversing trigger line (G5);
- ② and ③ are connected to the backup light "+";
- ④ connected to the backup light "-".

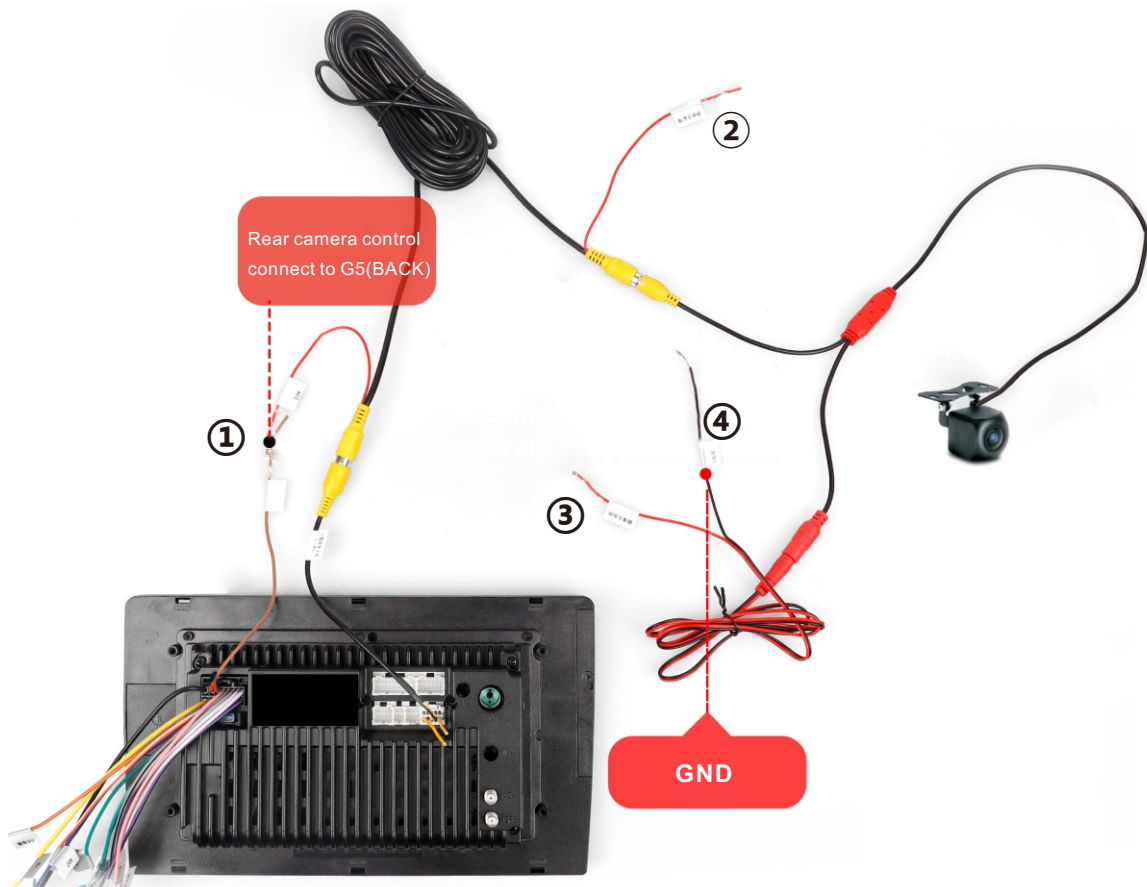

This is the connection principle of the rear camera. In most cases, it can be completed by directly connecting Back (Reverse) trigger line.

If there is no Back (Reverse) trigger line, then it is triggered by CANBUS, you need to set CANBUS, of course, there are some exceptions, please contact us!

Rear camera definition setting:

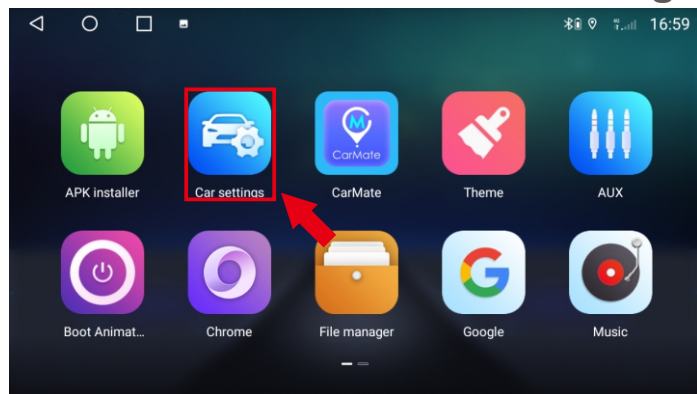

1. Click "Car Settings"

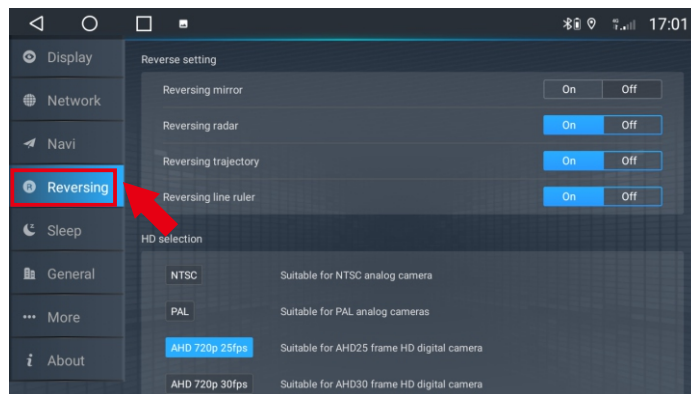

2. Click "Reversing"

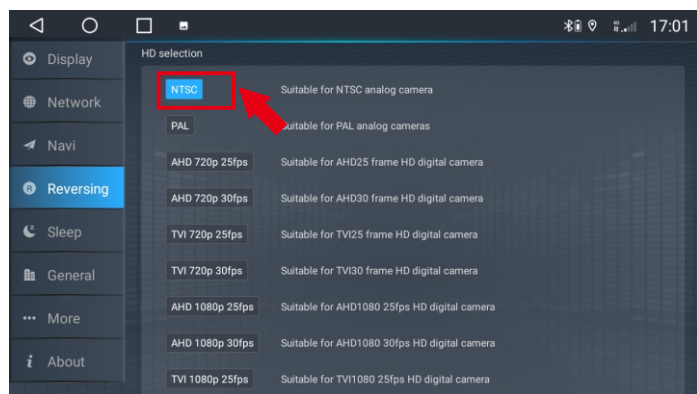

3. Choose the right camera format.

1.6 How the buttons on the steering wheel work?

A: If your order does not include canbus, please go to Steering Learning - follow the instructions to complete the steering learn.

Steering wheel learning steps:

1) Press any button on the steering wheel, the interface will display, please press and hold a direction button. If you do not press the button on the steering wheel within a certain period of time, the learning will fail.

2) Click on the screen to learn the function of docking.

3) Press the corresponding function button on the steering wheel.

Repeat the operation until all the control buttons on the steering wheel have been learned.

Please refer to this video:

<https://www.youtube.com/watch?v=O34gzkP1zPQ>



1. Click "Setting Wheel".

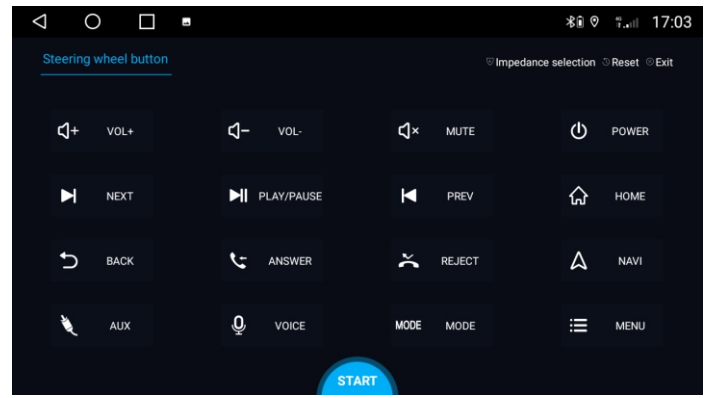

2. Click "START" to start the setting.

B: If your order includes canbus, please go to the Setting > Car settings > General > Extra settings > Password 123456 > Model choose > Chose your car model and save it .

1.7 How to adjust the car door direction?



The default display is the left driving position. If your car is the right driving position, please set it according to the following steps.

(Only the high-end car models that support CANBUS will show the car information, please ignore this information for other low-end car models)

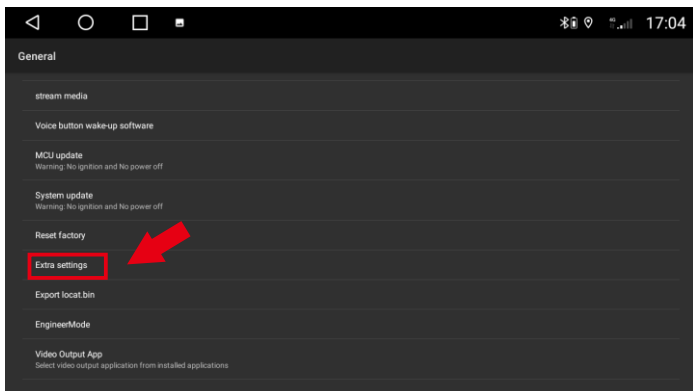

1. Click "Extra settings".

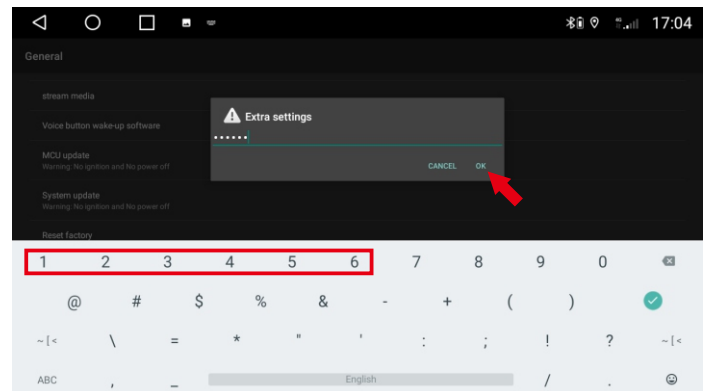

2. Enter password: 123456, click "OK".

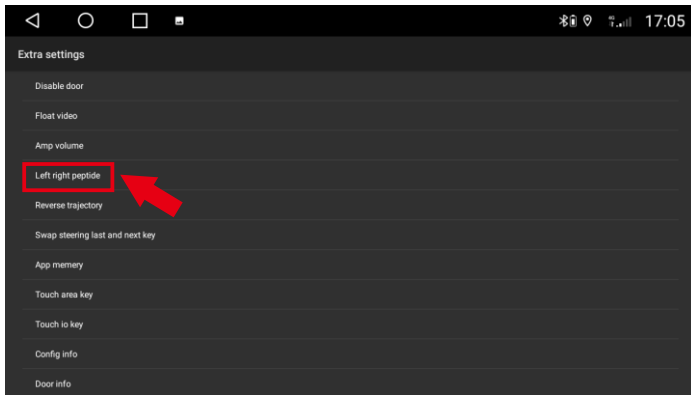

3. Enter "Left right peptide".

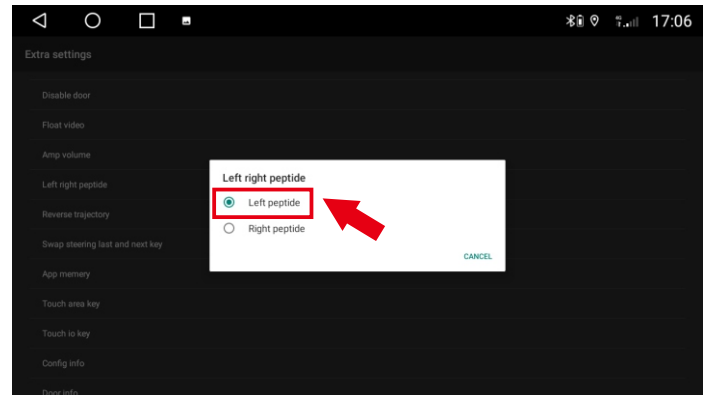

4. Select "Left Peptide" or "Right Peptide".

1.8 Can't turn off the DVD when my car is shut down?

A. Some car models do not completely cut off the power after turning off the engine. You need to open the door and then close the door to completely disconnect the power.

B. For Volkswagen cars (including Skoda), you need to do the following:

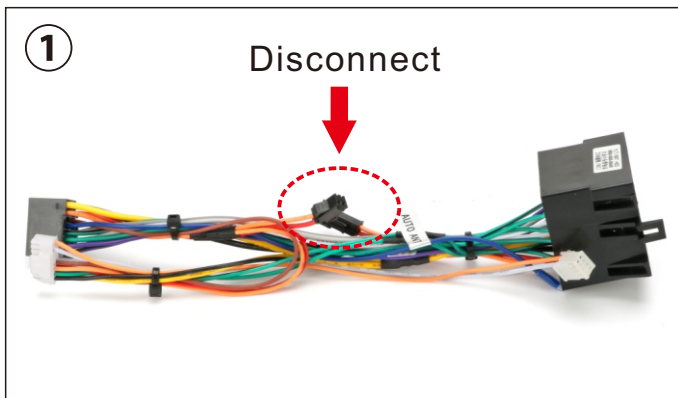

If you receive this power cable, please disconnect the place marked by the red circle, and the problem will be solved.

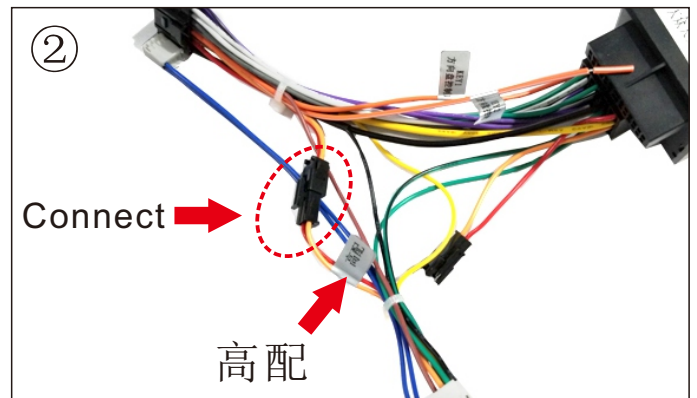

If you received this power cord, please connect the place marked with a red circle (the label is "高配"), and the problem will be solved.

1.9 Install USB DVR

If you purchased our USB DVR, please follow these steps:

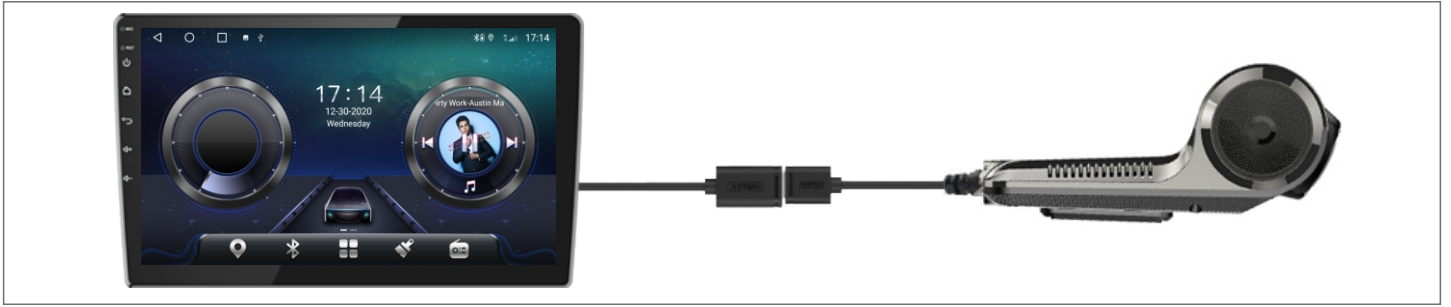

1. Connect DVR to Android Player by USB port.

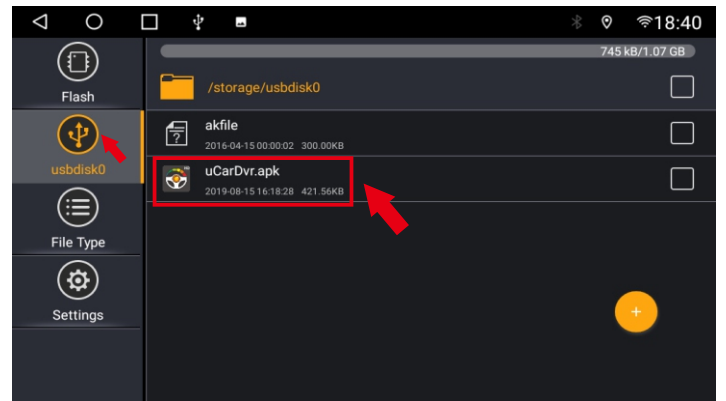
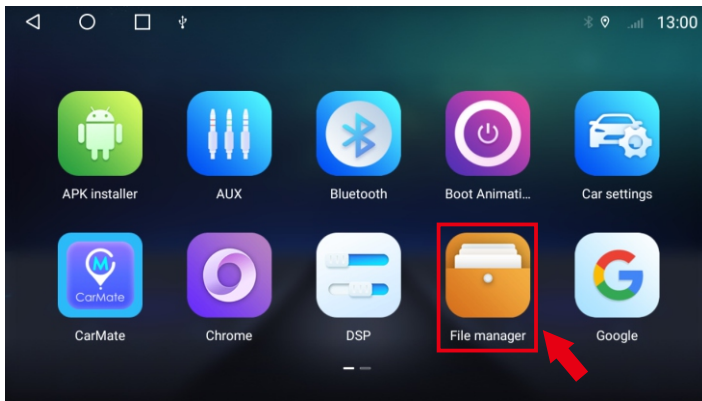

2. Open "File Manager".

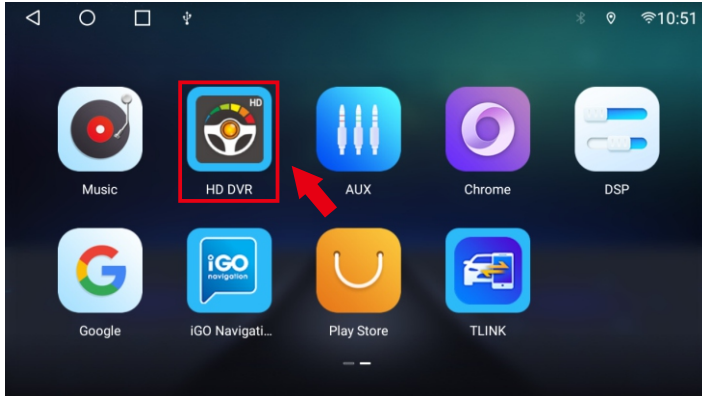

3. Click on "uCarDVR.apk" to install.

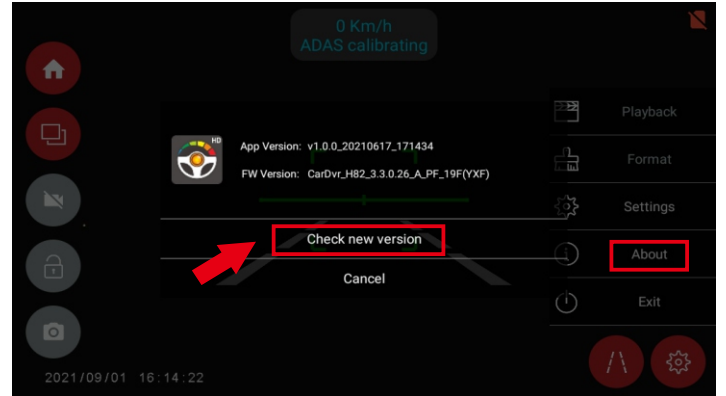

3. Open the apk.

4. Connect to the network and check the new version for upgrade.

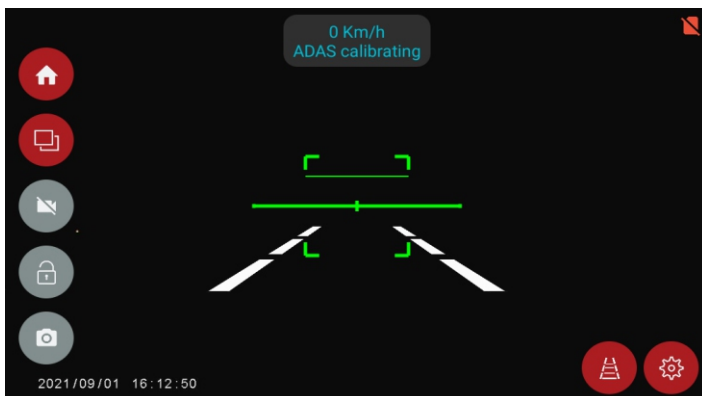

5. Start your experience!

1.10 Install USB TPMS

If you purchased our USB TPMS, please follow these steps:



1. Install sensors.



2. Connect receiver to DVD by USB port.



3. Connect U-disk to DVD by USB port.

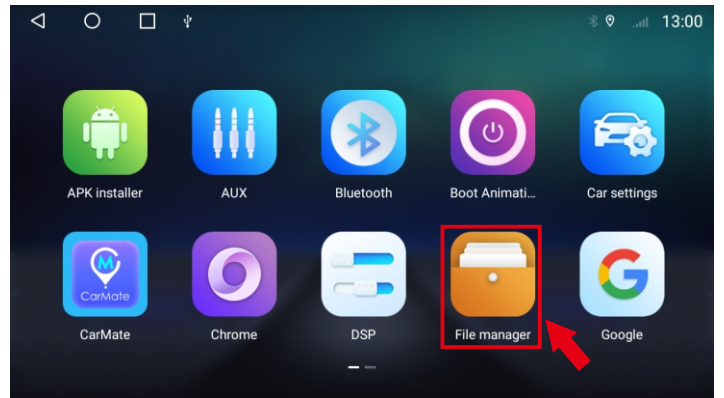

4. Open "File Manager".

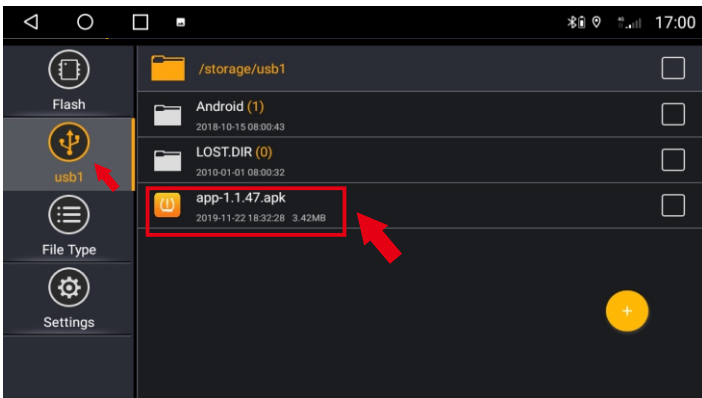

5. Click on "USB new.apk" to install.

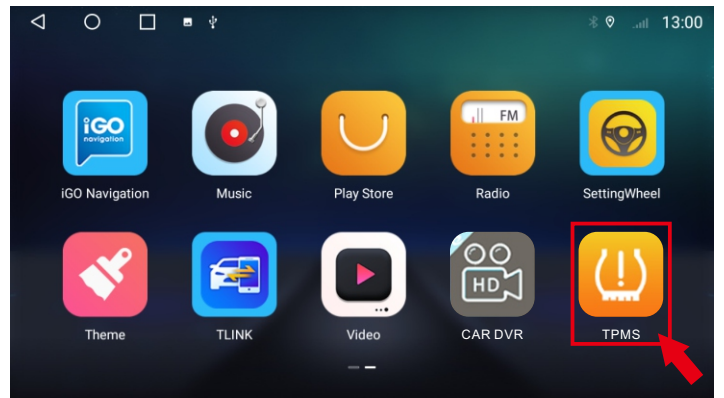

6. APP install success.

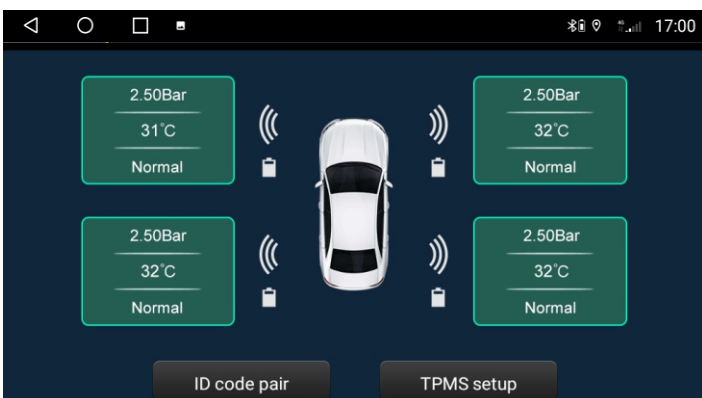

7. Use interface.



8. Pop-up warning display.

2. Basic operation

2.1 Turning On and Turning Off

Turning On

When you insert the key and turn on the car's ACC power, the device will automatically turn on and display the startup animation LOGO.

Turning Off

When you remove the key and turn off the car's ACC power, the device will automatically shut down.

2.2 Panel Function Button

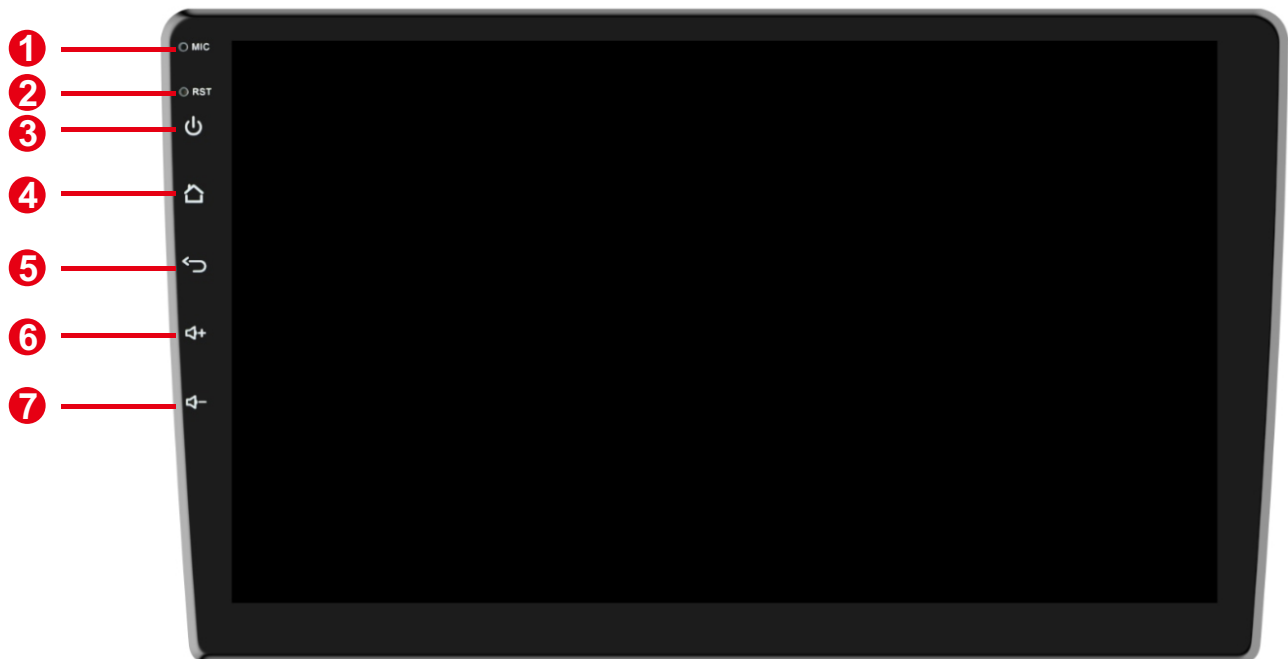

1 MIC Bluetooth call sound input

2 RST Click the reset button to reset the system and restart

3  Short press: mute
Long press: sleep mode

4  Back to Home page

5  Return to the previous interface

6  volume +

7  volume -

2.3 Tips for Using Touch Screen

When using the touch screen, you can operate the device in the following ways:

2.3.1 Clicking Function

You can select an app icon or option in the display by using the tap function. As in the screen, tap Bluetooth to enter the Bluetooth application.

2.3.2 Pressing Function

You can tap and hold the function, tap and hold the current operation interface, icon or input field for more operation options. For example: Tap and hold a blank area on the main interface, a pop-up menu will open at this time, and you can perform some options on the menu.

2.3.3 Dragging Function

Swipe the touch screen or tap and hold the scroll bar, then swipe up or down. For example: Use the swipe function when browsing the Bluetooth phonebook contact list.

2.3.4 Zooming Function

When you view a picture on your device, double-tap the screen to zoom in or out, or you can use two fingers to tap and hold the screen, then slide the distance between your fingers to zoom in or out.

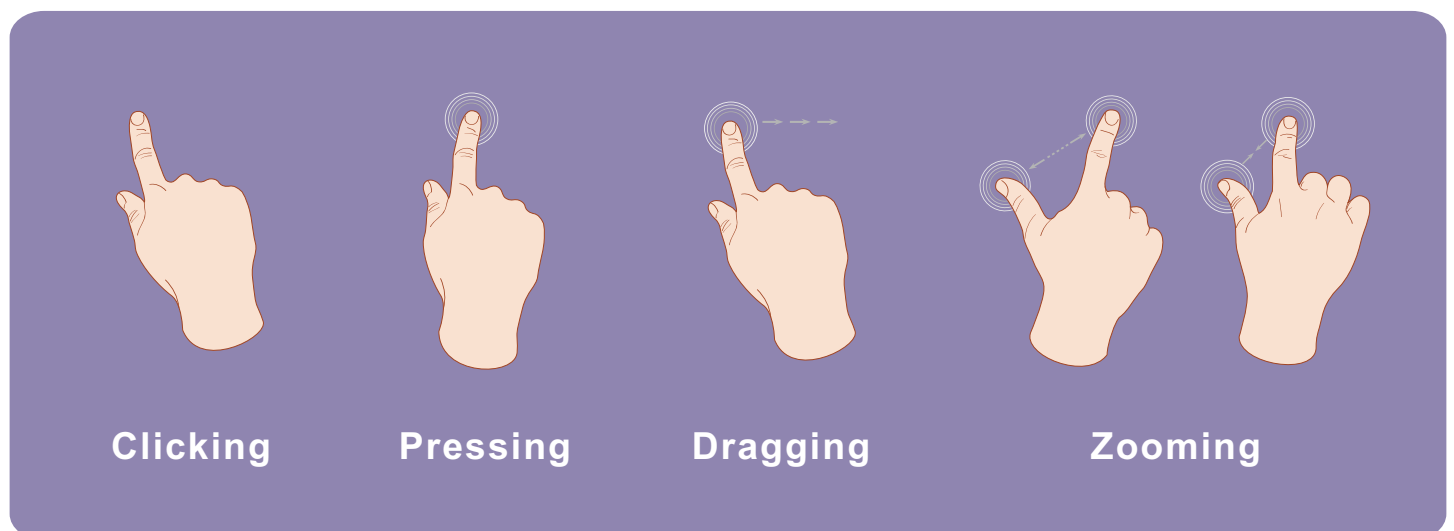

3. Function operation

3.1 Basic Settings

3.1.1 User Defined Home Screen

The device has 10 built-in UIs for use. Here are the steps to use:



1. Click "Theme" icon.

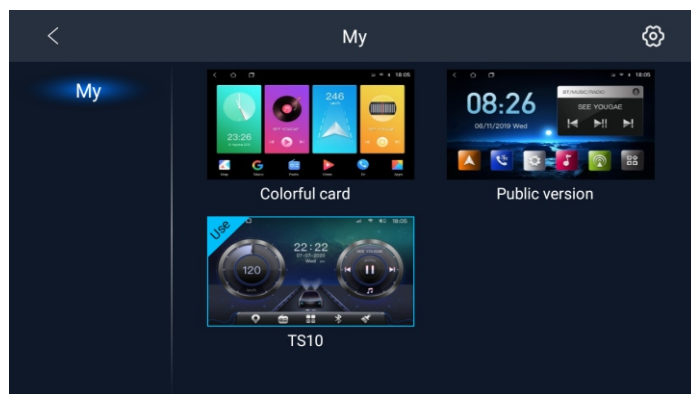

2. Choose the theme you need to set.

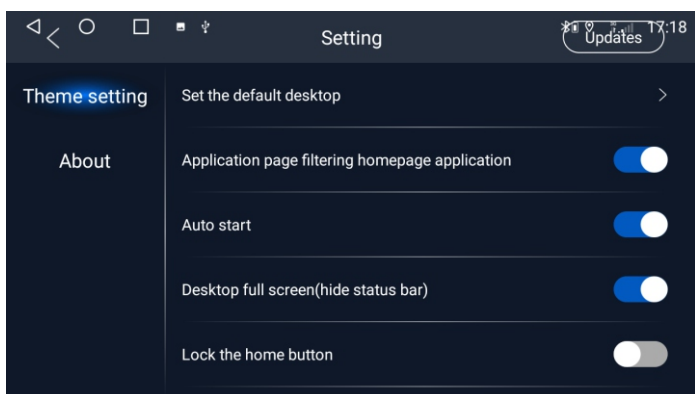

3. Theme setting interface.

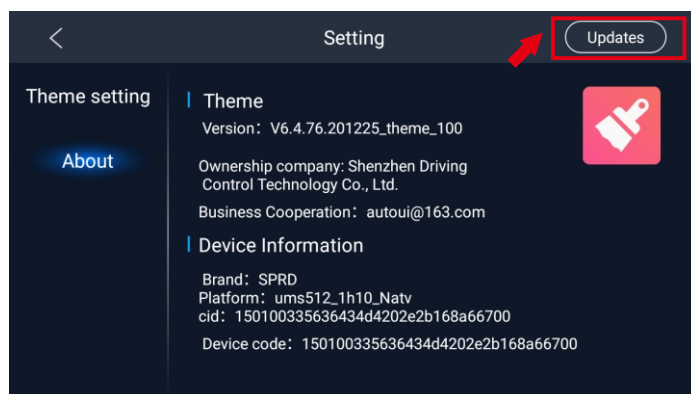

4. The theme can be updated.

3.1.2 Setting Wallpaper

Car settings > More > Display > Wallpaper > After selecting your favorite wallpaper, tap Set Wallpaper; or select a picture in the gallery and tap Save.

3.2 General

3.2.1 Steering Wheel

The user can set the steering wheel according to the prompts.

Note: The square control interface is only for cars with buttons on the steering wheel, but some cars cannot learn the steering wheel buttons, For example, olkswagen, Skoda, etc. are implemented through CANBUS.

Please refer to the video for steering wheel learning:

<https://www.youtube.com/watch?v=O34gzkP1zPQ>

3.2.2 Screen Calibration

Please use five fingers pressing on the screen at the same time. It will appear 4 points, click on the red point until the learning success. Then enter to learning the touch button.

Refer to video: https://drive.google.com/file/d/1Datdn-2M94oUmaR3IM3ImbwH_EwYtw6i/view?usp=sharing

3.2.3 Navigation application

Select the corresponding map application to associate the navigation application icon on the main interface:

Car Settings > Navi > Current selection > Select Navi app which you need.

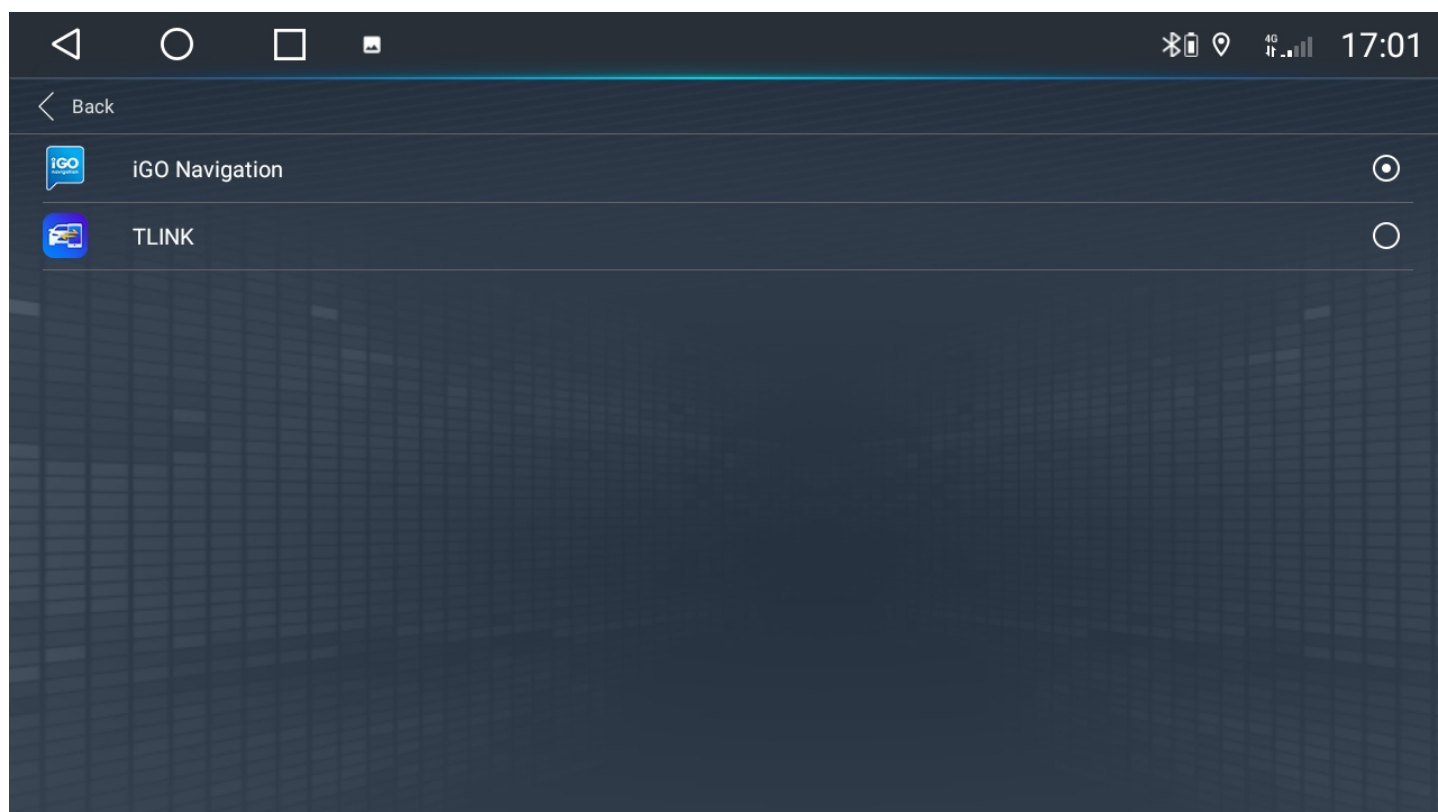

3.2.4 Language

If you need to change the language, follow these steps:

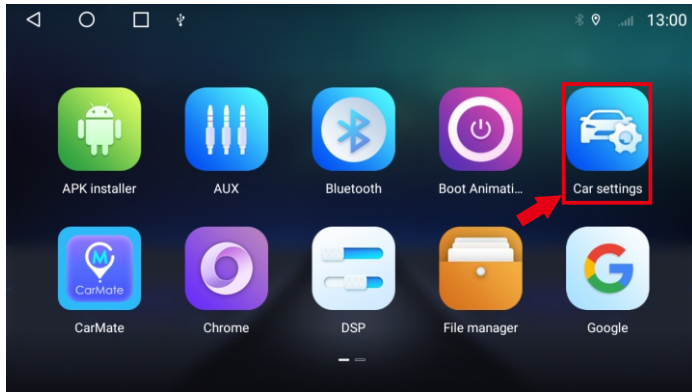

1. Click "Car Settings".

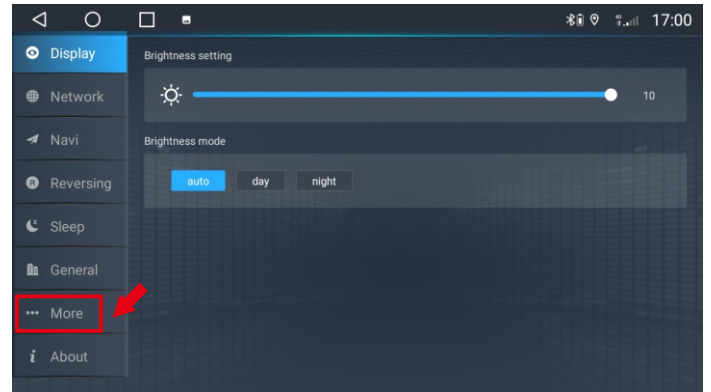

2. Click "More".

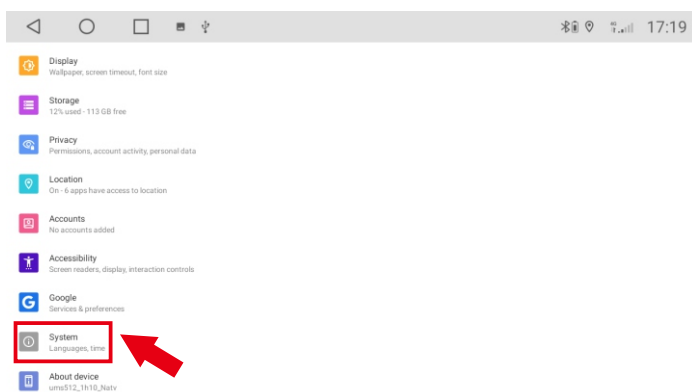

3. Click "System".

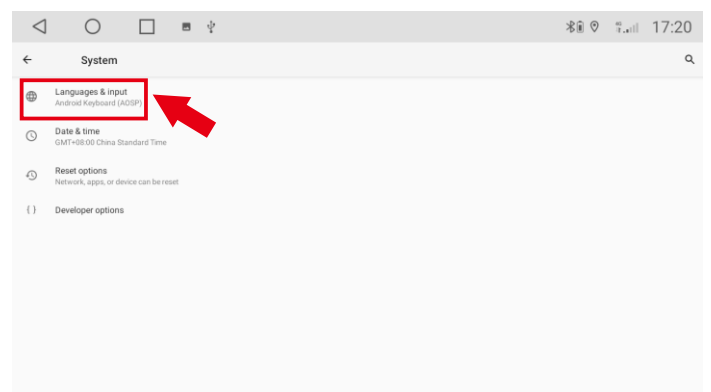

4. Click "Languages & input".

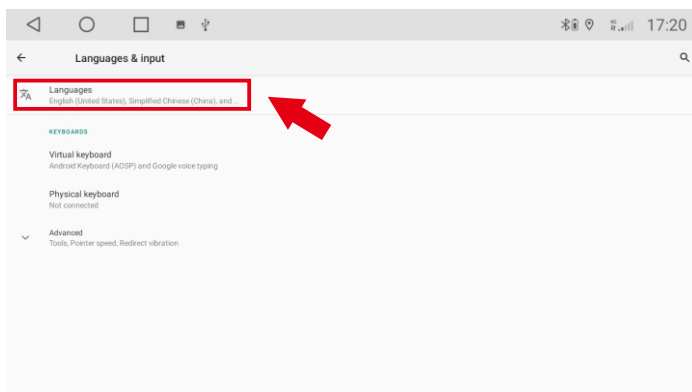

5. Click "Languages".

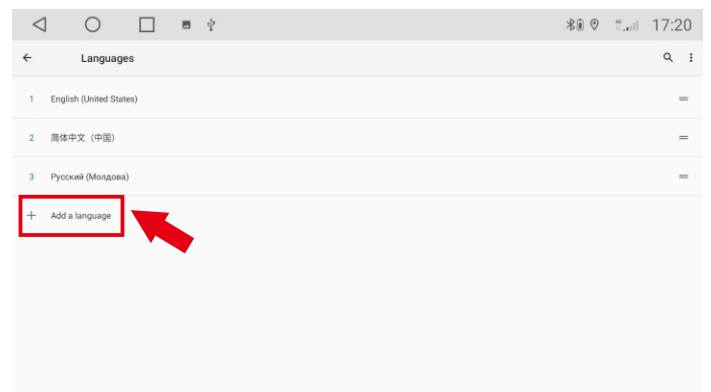

6. Click "Add a language" Select the language you need.

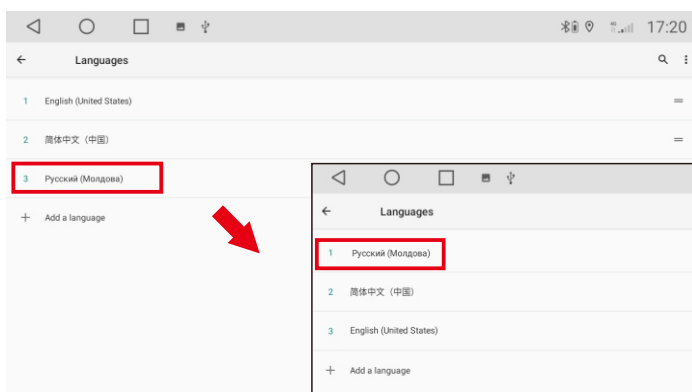

7. Long press the language and move up to 1th.

3.2.5 Factory settings

When the system is unavailable or a problem occurs after the user's operation, the system cannot be used normally, you can restore the factory settings. Restoring the factory settings of the system will delete the third-party software, and the current system settings will be lost. The navigation software only needs to reinstall the corresponding APK. Users should exercise caution.

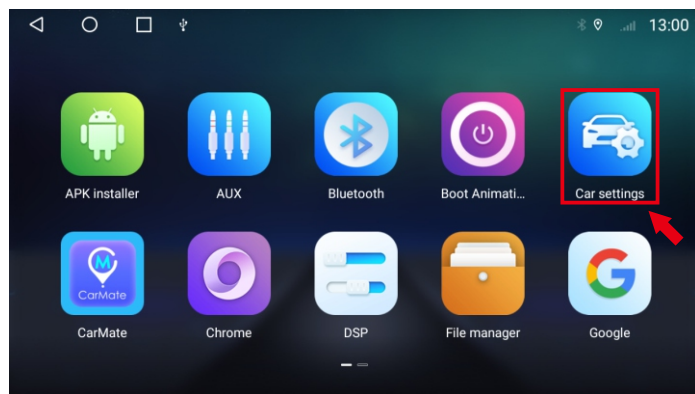

1. Click "Car Settings"

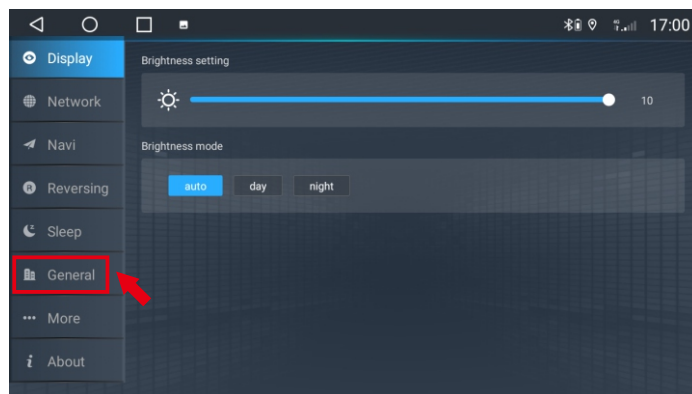

2. Click "General"

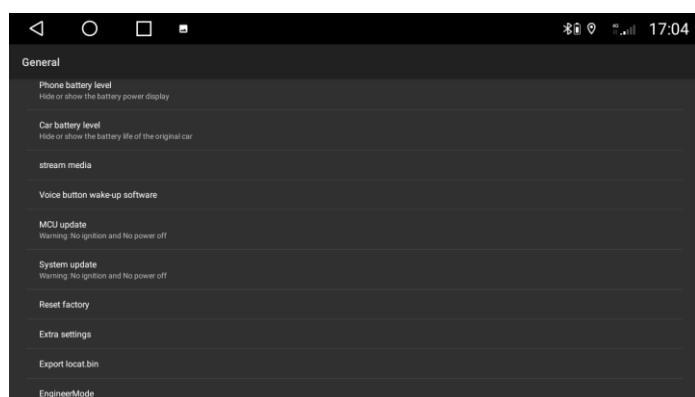

3. Click "Reset factory"

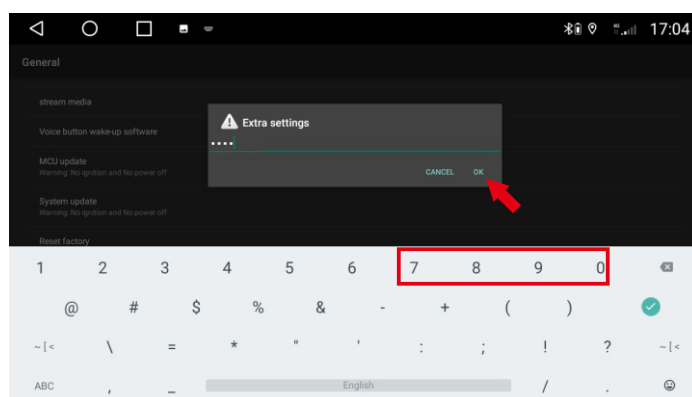

4. Enter the password: 7890, click "OK" and wait for the system to restart.

3.2.6 Split screen

Split screen function can display two apps at the same time, please follow the steps below:
Reference video: <https://drive.google.com/file/d/1MUvzfbzWOCqzUleuYNNEGJ4-MgIRi3Ms/view?usp=sharing>

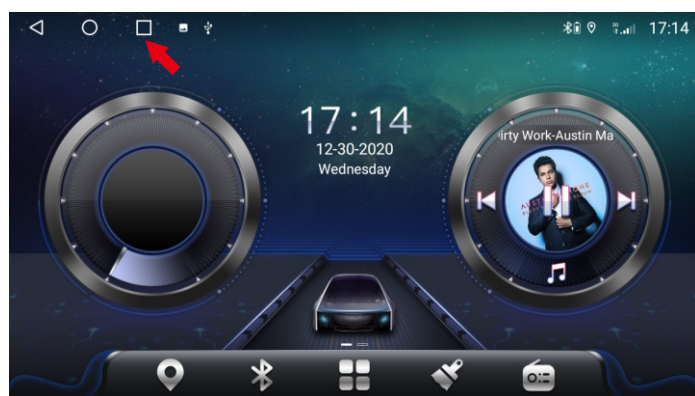

1. Click the icon to bring up all running apps.

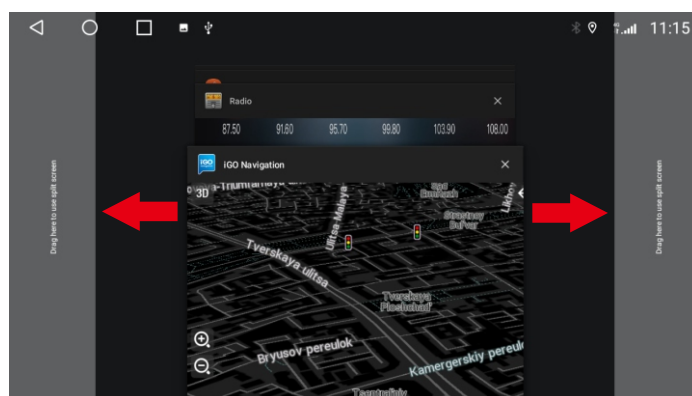

2. Hold one of the apps and drag it to the left or right prompt position.

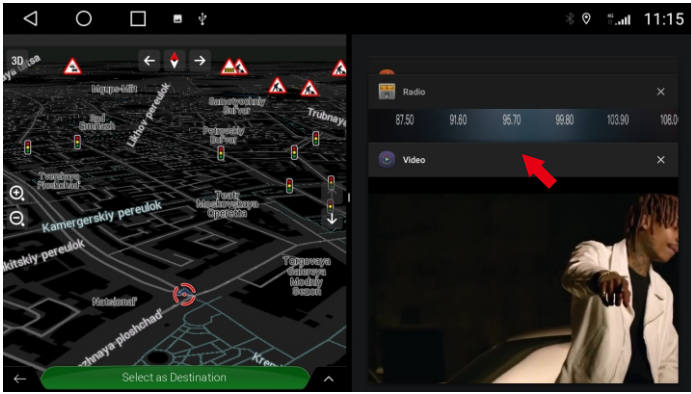

3. After entering split screen state, we gently tap (note that it is a click, not a drag) another app to let it automatically fill the other half of the screen.



4. In split screen state.

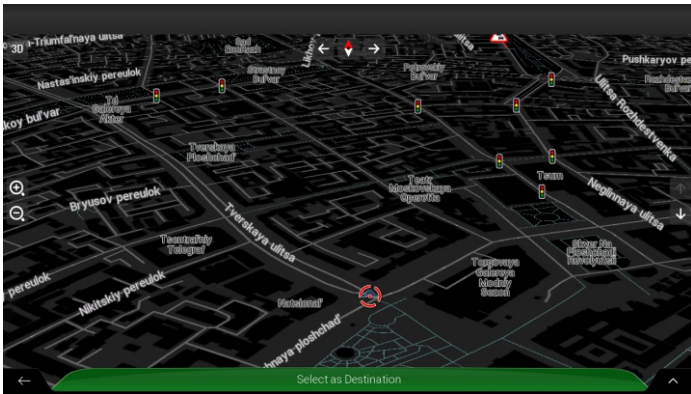

5. If you want to exit split screen, operation method is: hold down one of the apps, drag it all the way to the edge of the other side of screen, and then let go.

3.2.7 Float video settings

Float video function can make the video top the other apps. Setting steps:

Reference video: <https://drive.google.com/file/d/1yE1IABWqBU2z0RgRflfGnn5sNuZR3aag/view?usp=sharing>



1. On video play interface, click "Settings" icon.

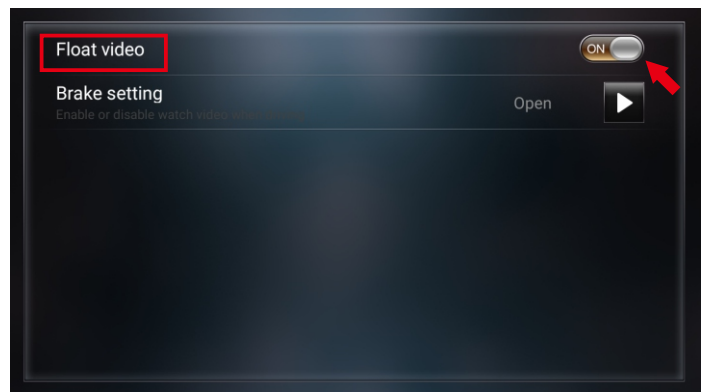

2. Float video set to "ON".



3. Play a video.



4. Click "HOME" button.



5. Video is top on any interface. Click close button above video to exit.



When you play a video, if the screen displays "Warning! Watching video while driving is prohibited", you only need to go through the settings to play the video normally, as shown in the figure.

Video playback interface > Settings
> Brake setting > Close

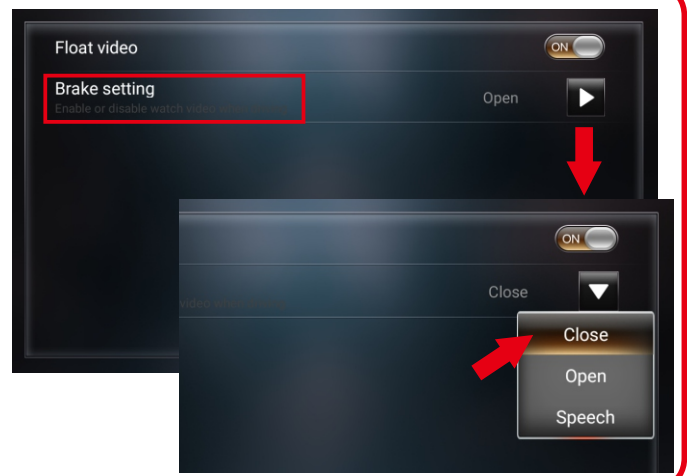

3.3 Navigation

You can download and install your favorite navigation application. Here are a navigation applications and download links we provide:



IGO MAP:

https://drive.google.com/drive/folders/1TiBpxFYRwcRpLPaE_VVLMNMRK5A3-oXJ?usp=sharing

3.4 Radio



3.4.1 Function Description

The functions of the icon buttons in the radio interface are described below:

Icon	Button name	Function Description
	RDS	Click to open RDS related functions.
	Auto Search	Scans and stores radio stations automatically.
	Search Channel Forwards	Click to search channel forwards then stop when find strong and clear channel.
	Search Channel Backwards	Click to search channel backwards then stop when find strong and clear channel.
BAND	FM / AM Switching	Click to switch FM / AM.
	LOC and DX switching	DX: More stations with stronger signals are searched, but not every station is clear enough; LOC: You can find clear and strong radio stations, but you can find fewer radio stations than remote stations.
	EQ	Click to enter EQ setting interface.
	Settings	Radio settings.
	Forward tuning	Forward tuning radio
	Back tuning	Back tuning radio

3.4.2 Select radio region

In order to have a better radio effect, please set radio area:

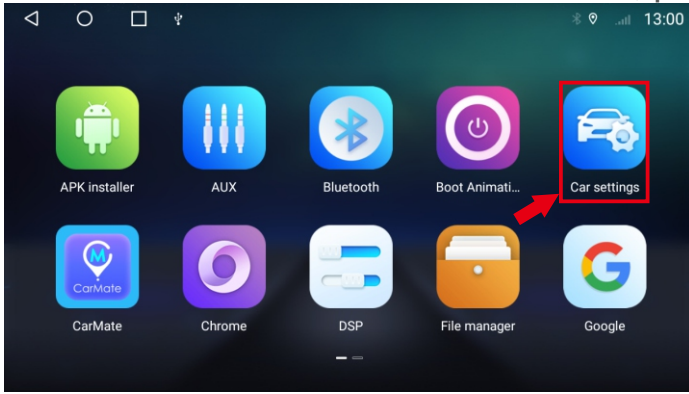

1. Click "Car Settings".

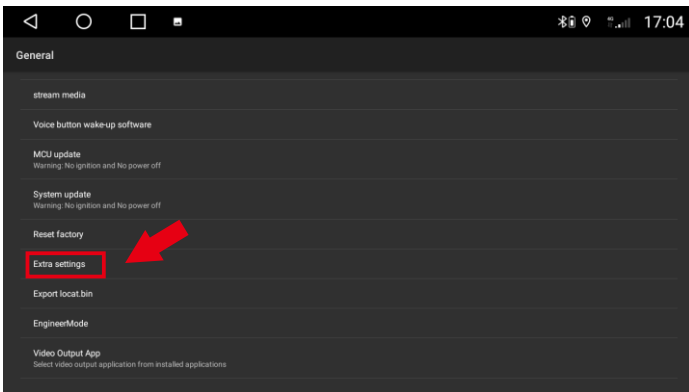

1. Click "Extra settings".

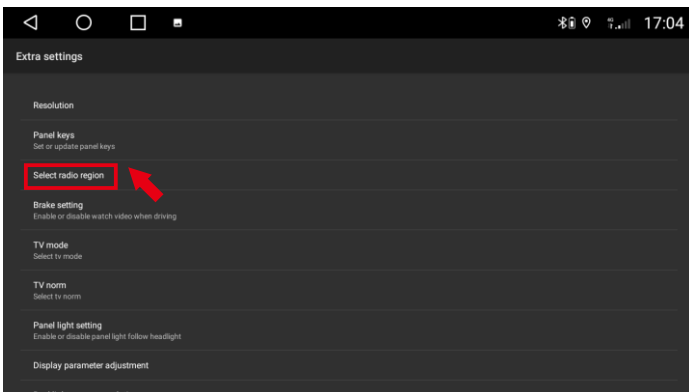

3. Click "Select radio region".

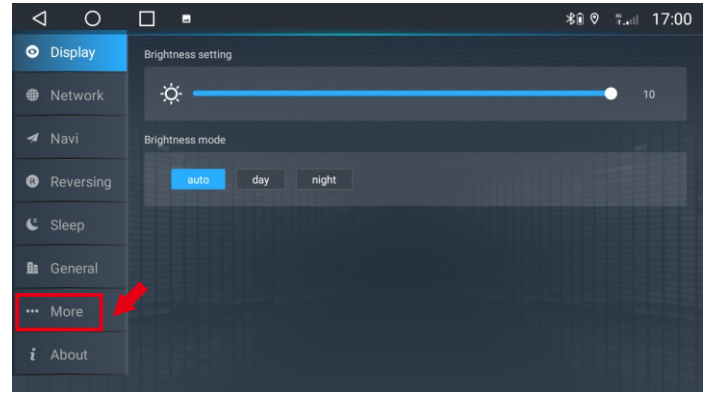

2. Click "More".

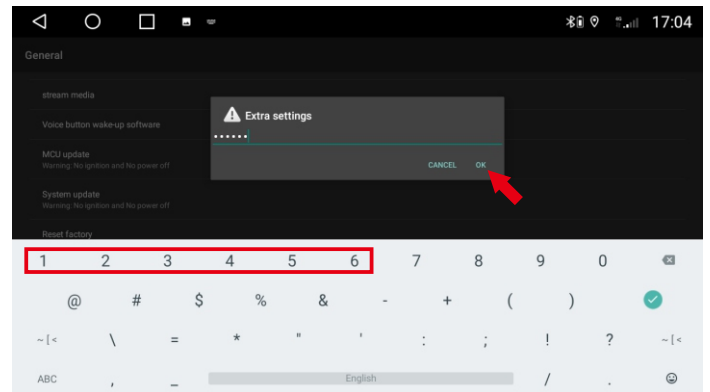

2. Enter password: 123456, click "OK".

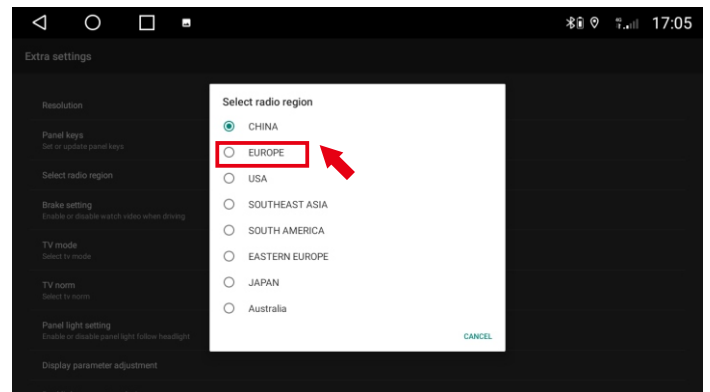

4. Select radio region.

3.4.3 Problems you may encounter?

The signal is not good:

Some models of the radio signal amplifier are in the original radio, and some models are in the radio antenna. If your car radio signal amplifier is in the original radio, then you need to install an additional signal amplifier to make the radio work properly. Also check your Antenna connection.

Please note: Volkswagen has a dual antenna interface (Figure 1), only one of the radio antenna interfaces needs to be connected. Very few buyers have a bad connection to one antenna interface, so you need to buy a dual antenna adapter (Figure 2). This machine does not include a dual antenna adapter.

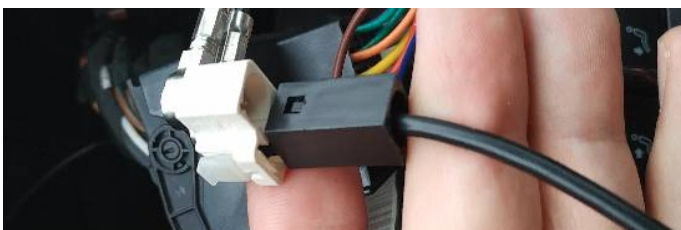

3.4.4 How to use Carplay?

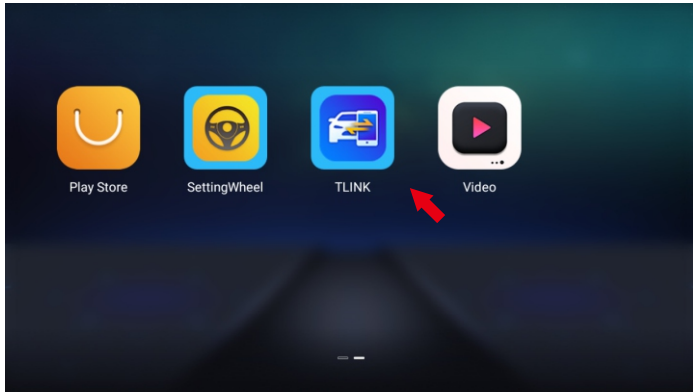

1. Click "TLINK".

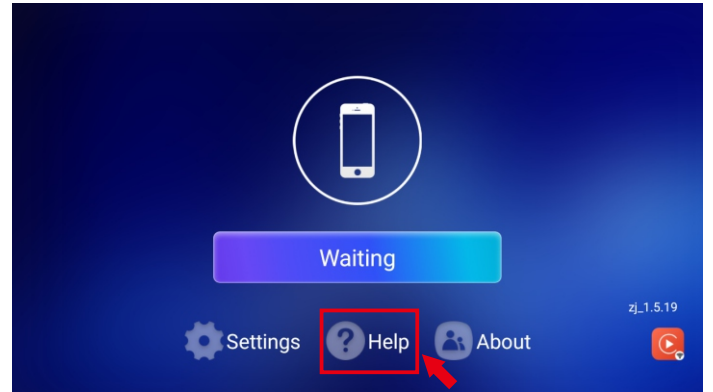

2. Click "Help".

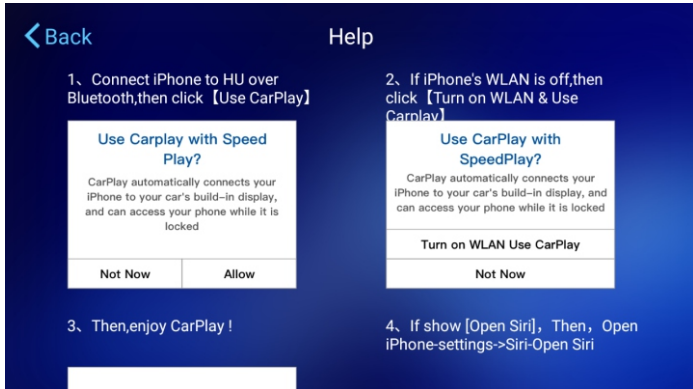

3. Follow the prompts.

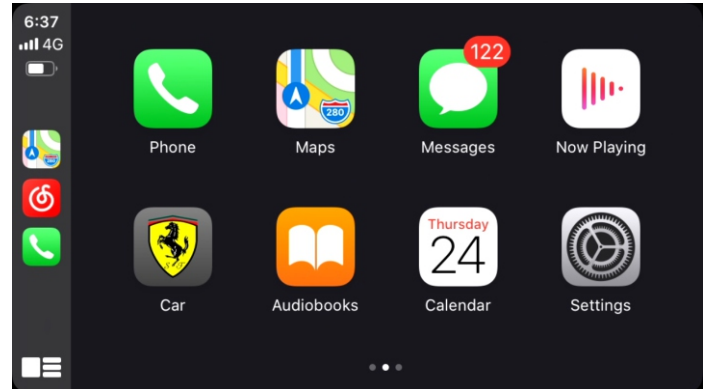

4. Connection succeeded.

3.4.5 How to use Android Auto?

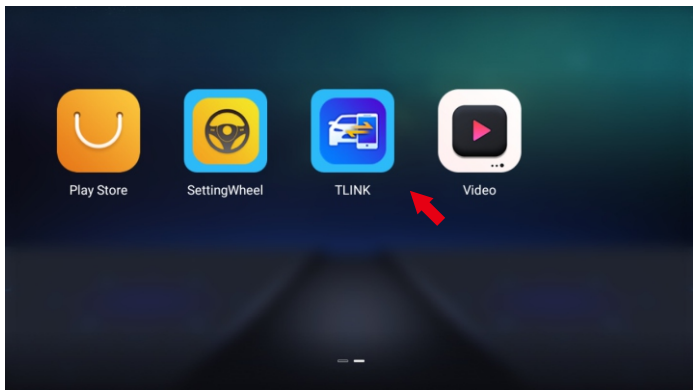

1. Click "TLINK".



2. Install "Android Auto" apk on the phone and connect radio with a USB cable.

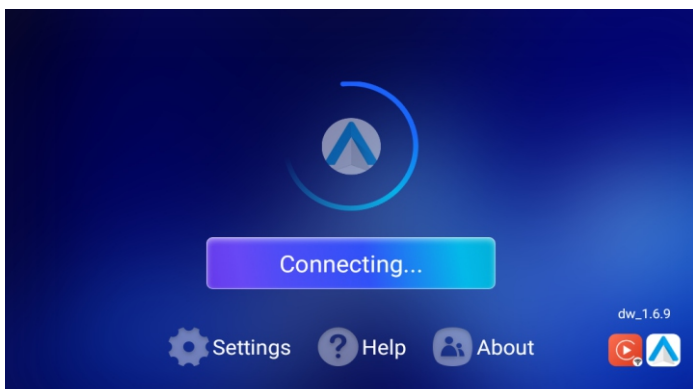

3. Automatically connecting.

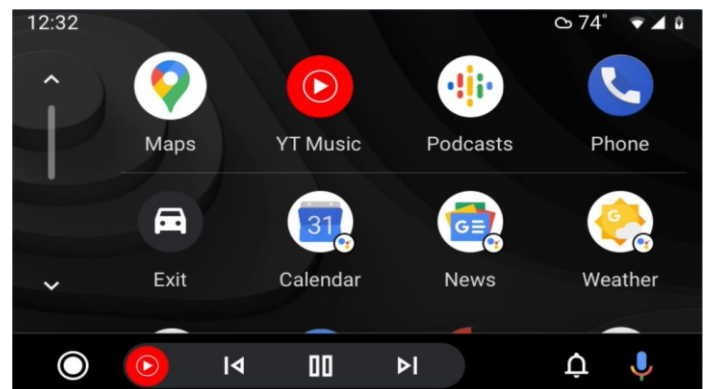

4. Connection succeeded.

4. Trouble handle

Android Player Guide Video URL:

https://drive.google.com/drive/folders/1vxtaZSP4gzOYAra_WsZy_m1Oiu3-gZRZ?usp=sharing

Note:

If you encounter the following problems during use, the troubleshooting wizard will help you solve the problem quickly. If the problem is still not solved, please contact the professional or contact us. Do not open the machine yourself to avoid serious consequences!

Q: Why can't I boot?

A: If you can't start, please rest assured, our machine will be tested before sending, usually the power connection problem, please follow the steps below to solve the problem.

1. The condition for the radio to turn on is that ACC (G3) and 12V (G2) are connected to the positive pole of the car's 12V power supply, and G1 is connected to the negative pole of the power supply. It is unlikely that the power cord may not match your car. You can directly connect these 3 power cords to check whether it is the power cord or the machine problem.
2. It may be that the cable of the radio has fallen off during transportation, just open the back cover to check and reconnect the cable inside the radio.
3. If the power cannot be turned on after following the above steps, please send us a video for confirmation. The video needs to show that the power cord is properly connected, and the connection cord is tested to 12V with an electric meter.

Q: Why doesn't GPS work?

A: Please check the following information first:

1. Please check if the GPS module is tightened.
2. Please click GPS monitoring to view the number of stars searched (normally display more than 3 green stars).
3. Please put the GPS module on the A pillar of the car.
4. Other electronic devices in the car will also interfere with GPS signals, please turn them off first.

There is a small amount of GPS interference that cannot work normally. You can send me a picture for confirmation. After confirmation, I will send you a new GPS module.

Q: Why does the Bluetooth connection fail?

A: Please turn on bluetooth of the phone, and then search for the device name on the phone.

1. Please check if the video input cable is plugged in. The two short blue cables are the receiving signals of Bluetooth and WiFi.
2. Please ignore the connected devices on your phone and reconnect.
3. Please try to connect with another phone.

Q: Why does the left button light not light up?

A: Check if G4 on the power cord is connected to ACC.

Q: How to proofread the guide buttons?

A: Car settings--General--Extra settings(123456)--Touch area Key, click Start--click Clear, and then click each key to learn.

Q: Boot logo setting?

A: Car settings--General--Extra settings(123456)--LOGO setting (Support custom startup picture)

Q: Why is the sound of the player low & noisy background sounds appear when playing music?

A: This is electronic equipment or power interference, you need to contact us to buy filters

Q: Why is there no original car setting when CANBUS is included, or the original car has abnormal functions?

A: Need to connect the machine to the network to update the CANBUS library, check or reset CANBUS.

Q: How to wire Outlander 2 2005-2011/Lancer 2007-2013 with Rockford amplifier:

A1: If you have an RCA cable, please connect the RCAAMP CTRL cable and AMP CONT cable together, and the sound will work normally. Please refer to the figure below,

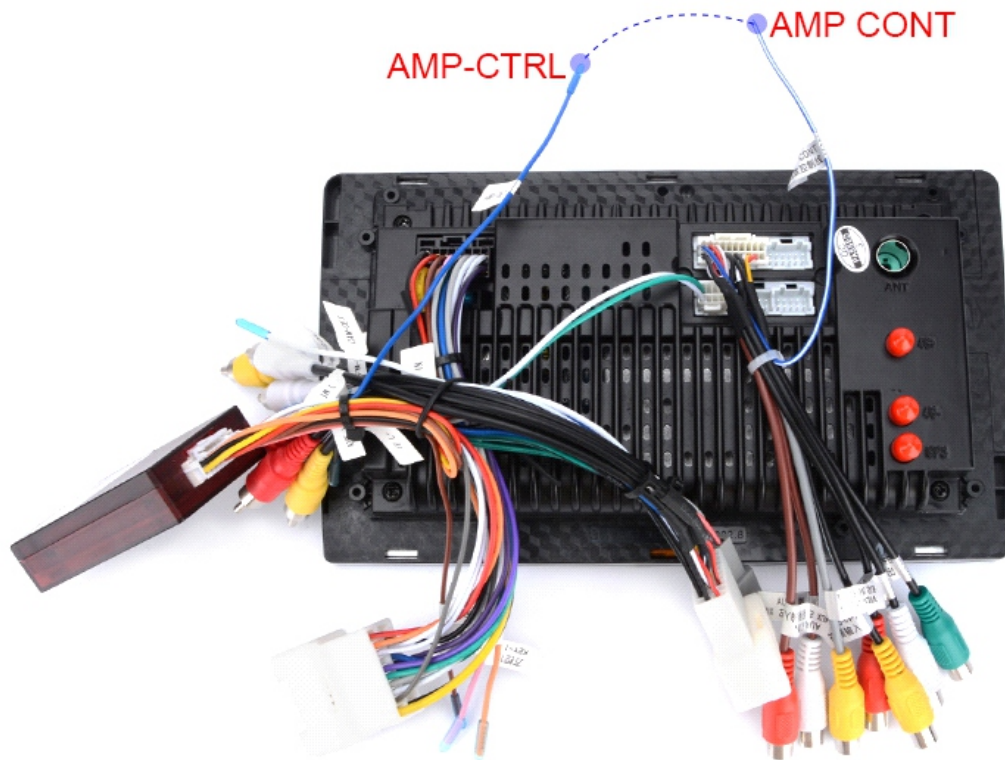

A2: If there is no RCA cable, please find the AMP CTRL cable and connect it to the ACC cable (red), just remove the plastic and it will not cut. Please refer to the figure below

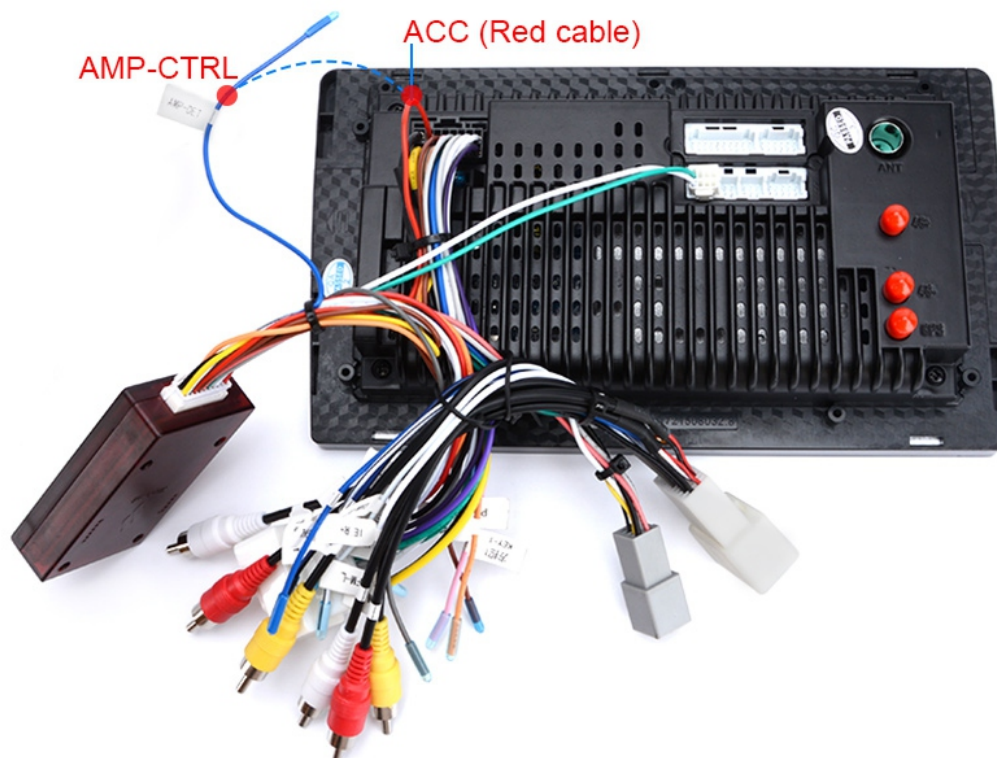

5. Hot product for this machine



USB ADAS Car DVR For Android

- ADAS Plus Make Driving Safer
- Floating window function
- Easy to install



USB TPMS For Android

- Temperature monitoring
- Pressure monitoring
- Pop-up warning



HD Rear Camera

- Night Vision
- Waterproof

During use, if any question, please feel free to contact us directly.
E-mail: aliexpress-2019@foxmail.com