

Applies To: **See VEHICLES AFFECTED**

**September 24, 2010**

## Windshield Wipers Intermittently Do Not Park or Turn Off (Supersedes 07-071, dated June 5, 2009; see REVISION SUMMARY)

### REVISION SUMMARY

Most sections were revised extensively. American Honda recommends that you review the entire service bulletin.

### SYMPTOM

When the windshield wipers are turned off, they intermittently do not park at the correct location at the bottom of the windshield, or they continue to run.

The symptom is usually more noticeable in colder weather; however, it is difficult to reproduce. If you have a vehicle that reportedly has this symptom, replace the windshield wiper motor cover plate.

### PROBABLE CAUSE

The windshield wiper motor cover plate is faulty.

### VEHICLES AFFECTED

#### 2006 Civic 4-Door – ALL

#### 2007 Civic 4-Door –

From VIN 1HGFA1...7L000001 thru  
1HGFA1...7L131567

From VIN 2HGFA1...7H300001 thru  
2HGFA1...7H305661

From VIN 2HGFA1...7H500001 thru  
2HGFA1...7H509516

From VIN 2HGFA5...7H700001 thru  
2HGFA5...7H712789

From VIN JHMFA1...7S000001 thru  
JHMFA1...7S009779

#### 2006 Civic GX – ALL

#### 2007 Civic GX –

From VIN 1HGFA4...7L000001 thru  
1HGFA4...7L000902

#### 2006 Civic Hybrid – ALL

#### 2007 Civic Hybrid –

From VIN JHMFA3...7S000001 thru  
JHMFA3...7S028966

#### 2007 CR-V –

From VIN 5J6RE.8..7L000001 thru  
5J6RE.8..7L007622

From VIN JHLRE38..7C000001 thru  
JHLRE38..7C070895

From VIN JHLRE48..7C000001 thru  
JHLRE48..7C109723

### CORRECTIVE ACTION

Replace the windshield wiper motor cover plate.

### PARTS INFORMATION

Wiper Motor Cover Plate:

*Civic, Civic GX, Civic Hybrid –*  
P/N 76505-SNA-305

*CR-V –*  
P/N 76505-SWA-305

### WARRANTY CLAIM INFORMATION

The normal warranty applies.

Operation Number: 7401C9

Vehicle	FRT	Failed P/N	Template ID
Civic, Civic GX, Civic Hybrid	0.8	P/N 76505-SNA-A02	07-071A
CR-V	0.7	P/N 76505-SWA-A02	07-071B

Defect Code: 03214

Symptom Code: 03220

Skill Level: Repair Technician

## REPAIR PROCEDURE

NOTE: This procedure is in an outline form that you can also use as a checklist for the repair. If you need more details on the item listed below, bookmark it in the appropriate service manual, or view it online.

### • Wiper Motor Replacement.

1. Open the hood. Remove the caps, the nuts, and the windshield wiper arms.
2. Remove the cowl covers.
3. Remove the bolts and the under-cowl panel.
4. Disconnect the 5P connector from the wiper motor, and remove the wiper linkage assembly (Civic; six bolts, CR-V; four bolts). Then remove the wiper motor.
5. Remove the four screws from the cover plate.

**CR-V shown/ Civic similar**

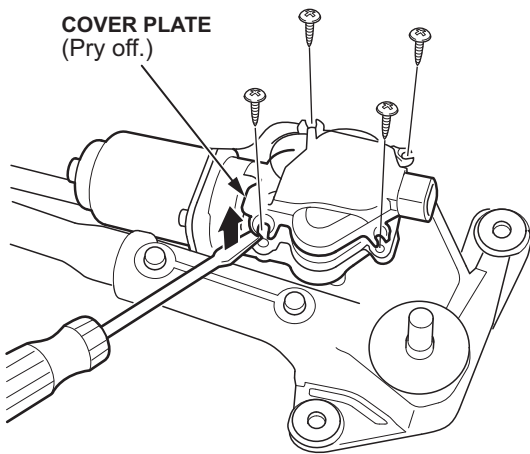

6. Using a flat-tip screwdriver, partially pry up the cover, using the connector for leverage. Then partially pry up the opposite side using the screw boss for leverage.

NOTE: Be careful not to damage the motor gear case.

7. Pull the cover straight off the motor case.

NOTE: Be careful not to contaminate the internal coupler and gears butyl sealer, grease, or other debris.

**CR-V shown/ Civic similar**

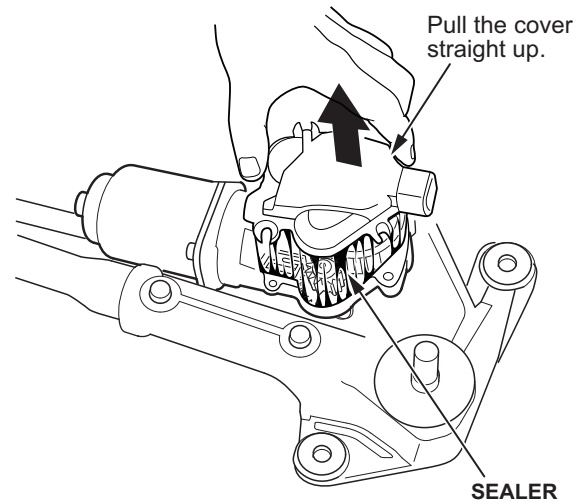

8. Using some grease from the original cover plate or the motor gear case, grease the new cover plate at the three locations shown.

**CR-V shown/ Civic similar**

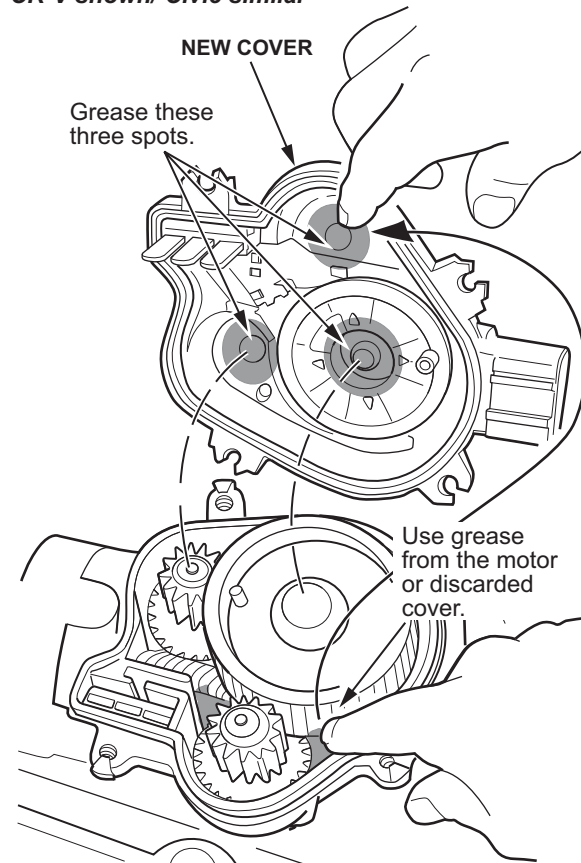

9. Install the cover plate onto the motor with the internal coupler terminals aligned. Make sure the new cover plate boss is about 180 degrees out of phase from the spur gear boss.

**CR-V shown/ Civic similar**

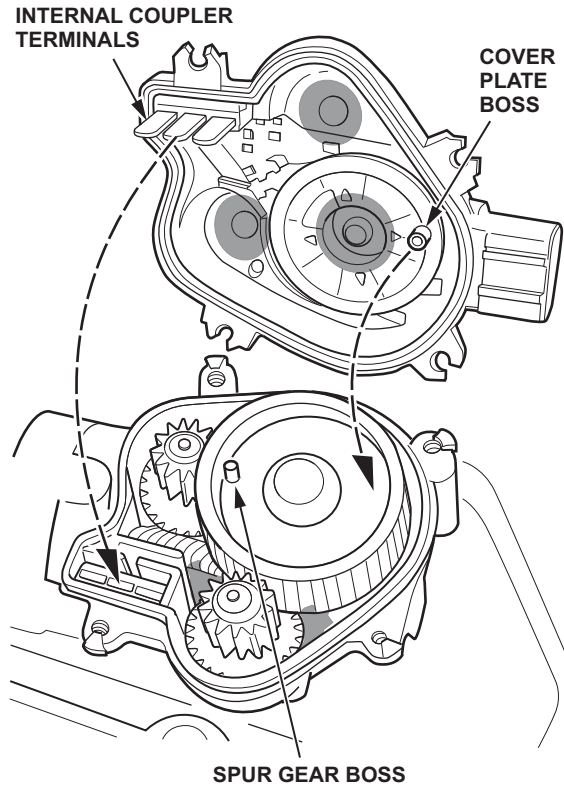

10. Install the four screws, and tighten them in a cross pattern until all are tight.
11. Before installing the wiper motor, connect the wiper motor 5P connector to the motor connector, and turn the ignition switch to ON (II).
12. Turn the wiper switch ON then OFF to return the wiper shafts to the park position.
13. Turn the ignition switch to LOCK (0).

14. Disconnect the wiper motor 5P connector from the wiper motor.
15. Reinstall the wiper linkage assembly into the vehicle, and reconnect the wiper motor 5P connector.
16. Verify the wiper motor operation and park position before reinstalling the wiper blades.
17. Reinstall the under-cowl panel, the cowl covers, and the windshield wiper arms.